

Our ref: T170521 Stages 1,2,3



5 June 2020

Thave Thavendran
Dalton Consulting Engineers PTY LTD
Level 3, 678 Victoria Street
Richmond VIC 3121

Dear Thave,

Re: Functional layout plans – Wattle Estate, 190 Kenilworth Avenue, Beaconsfield

The functional layout plans, listed below, for the above project, have been examined and generally accord with the requirements of the Planning Permit and the MPA Engineering Design and Construction Guidelines.

- 18144FTD01
- 18144FTD02-03
- 18144FSP01
- 18144FDP01-02
- 18144FPB01-02
- 18144FID01-02
- 18144FTT01-06

These plans are therefore approved and are considered to satisfy the requirements of Condition 35 of Planning Permit T170521.

If you have any queries regarding these matters, please contact Infrastructure Services unit on 1300 787 624.

Yours faithfully

Justin Conn
Development Project Engineer

**BEACONSFIELD WATTLE ESTATE
CARDINIA SHIRE COUNCIL
STAGE 1-6
190 KENILWORTH AVENUE, BEACONSFIELD**

FOR

FUNCTIONAL LAYOUT PLAN APPROVAL

CARDINIA SHIRE COUNCIL

Ref No.: T170521 - Stages 1,2,3

Sheet: 1 of 17

Approved by: Justin Conn

CARDINIA SHIRE COUNCIL

Date: Friday, 5 June 2020



**CIVIL DRAWINGS
ROADS AND DRAINAGE**

**DCE REF: 18144F
MELWAYS: 214 C5**

Approval Note:

These plans are approved subject to a review of the parking bay and threshold treatment details shown, these will be assessed with construction plans to be submitted.

**NOT TO BE USED
FOR CONSTRUCTION**

FUNCTIONAL

GENERAL NOTES

- ALL LEVELS ARE TO AUSTRALIAN HEIGHT DATUM AND ALL COORDINATES ARE TO MAP GRID OF AUSTRALIA (MGA) ZONE 55.
- ALL WORKS TO BE CARRIED OUT IN ACCORDANCE WITH VPA GUIDELINES, AS4000 GENERAL CONDITIONS OF CONTRACT, THE ROAD & DRAINAGE SPECIFICATION, APPROVED CARDINIA SHIRE COUNCIL SPECIFICATION AND STANDARD DRAWINGS, AND TO THE SATISFACTION OF THE SUPERINTENDENT AND THE CITY ENGINEER OR HIS REPRESENTATIVE.
- A PRE-COMMENCEMENT MEETING WITH COUNCIL IS TO BE ARRANGED PRIOR TO COMMENCEMENT OF THE WORKS.
- ALL SERVICE AUTHORITIES SHALL BE NOTIFIED IN WRITING SEVEN DAYS PRIOR TO COMMENCEMENT OF THE WORKS.
- TBMS TO BE RE-ESTABLISHED BY THE LICENSED SURVEYOR IF FOUND TO BE MISSING AT THE COMMENCEMENT OF CONSTRUCTION. THE CONTRACTOR WILL BE RESPONSIBLE FOR CARE AND MAINTENANCE OF TBMS THEREAFTER.
- ALL EXISTING SURFACE LEVELS SHOWN ON THE ENGINEERING DRAWINGS HAVE BEEN INTERPOLATED FROM A DIGITAL TERRAIN MODEL. THESE LEVELS HAVE BEEN USED AS THE BASIS FOR ALL ENGINEERING DESIGN AND DETERMINATION OF QUANTITIES.
- THE CONTRACTOR IS REQUIRED TO CONFINE CONSTRUCTION VEHICLES TO THE ROAD RESERVE AND EASEMENTS. ANY DAMAGE CAUSED TO ALLOTMENTS MUST BE MADE GOOD.
- ANY BUILDINGS, TROUGHS, FENCES AND OTHER STRUCTURES ON SITE ARE TO BE REMOVED AS DIRECTED BY THE ENGINEER. THE COST OF REMOVAL IS TO BE INCLUDED IN THE OVERALL EARTHWORKS FIGURE UNLESS A SPECIFIC ITEM FOR REMOVAL IS DENOTED IN THE SCHEDULE.
- FILL AREAS IN EXCESS OF 300mm ARE TO BE STRIPPED OF TOPSOIL, FILLED, AND TOPSOIL REPLACED TO OBTAIN THE FINAL FILL LEVELS SHOWN ON THE DRAWINGS. ALL FILLING MUST ENSURE LEVEL 1 GEOTECHNICAL SUPERVISION IS MAINTAINED AS PER CLAUSE 8.2 OF AS3798 "GUIDELINES ON EARTHWORKS FOR COMMERCIAL AND RESIDENTIAL DEVELOPMENTS". STRUCTURAL FILLING MATERIAL IS TO BE APPROVED BY THE SUPERINTENDENT AND COUNCIL PRIOR TO PLACEMENT.
- NO FILL OR STOCKPILING OF MATERIAL IS TO BE PLACED ON ANY RESERVE OR COMMON PROPERTY UNLESS OTHERWISE DIRECTED BY THE ENGINEER. NO TOPSOIL IS TO BE REMOVED FROM SITE. SURPLUS SOIL MUST BE MADE AVAILABLE FOR LOTS AND RESERVES.
- WHERE PAVEMENT IS CONSTRUCTED ON FILLING, FILL MATERIAL IS TO BE APPROVED BY THE SUPERINTENDENT AND COUNCIL AND CONSTRUCTED IN LAYERS 150mm THICK WITH COMPACTION IN ACCORDANCE WITH AS3798. PRIOR TO THE PLACEMENT OF THE FILL MATERIAL UNDER NEW PAVEMENTS, APPROVAL OF THE MATERIAL TO BE USED MUST BE OBTAINED FROM COUNCIL.
- WHEN PAVEMENT EXCAVATION IS IN ROCK ALL LOOSE MATERIAL (INCLUDING ROCKS AND CLAY) MUST BE REMOVED. THE SUB-GRADE MUST THEN BE REGULATED WITH COUNCIL APPROVED MATERIAL.
- AT LEAST 3 DAYS BEFORE COMMENCING EXCAVATION OF TRENCHES IN EXCESS OF 1.5m DEPTH, A COMPLETED "NOTICE OF INTENTION TO COMMENCE TRENCHING OPERATIONS" FORM SHALL BE SENT TO WORKSAFE VICTORIA. THE NOMINATED SUPERVISOR SHALL BE SUITABLY QUALIFIED IN ACCORDANCE WITH VICTORIAN OHS ACT 1985 & COMMONWEALTH OHS CODE OF PRACTICE 2008.
- NO BLASTING TO BE CARRIED OUT WITHIN 20 METRES OF EXISTING SERVICES.
- ALL TREES AND SHRUBS ARE TO BE RETAINED UNLESS OTHERWISE SHOWN. IF ROAD AND DRAINAGE CONSTRUCTION NECESSITATES THEIR REMOVAL, WRITTEN PERMISSION MUST BE OBTAINED FROM THE ENGINEER.
- ALL DISTURBED SURFACES SHOULD BE OVER EXCAVATED BY 150mm, TOP SOILED WITH MINIMUM 150mm OF LOCAL TOP SOIL AND BITUMEN STRAW HYDROSEEDDED.
- ALL BLOCKS ARE TO SURFACE GRADE WITH A MINIMUM FALL OF 1 IN 150 ALONG THE LOW SIDE BOUNDARY TO THE POINT OF DISCHARGE.
- ALL BATTERS SHALL BE 1 IN 6, UNLESS OTHERWISE SHOWN.
- ALL CHAINAGES REFER TO ROAD RESERVE CENTRELINES EXCEPT - IN COURT HEADS WHERE CHAINAGES REFER TO LIP OF KERB - KERB RETURNS WHERE CHAINAGES REFER TO LIP OF KERB.
- GENERALLY SM2 KERB AND CHANNEL IS TO BE USED THROUGHOUT THE SUBDIVISION. WHERE OTHER KERB TYPES ARE REQUIRED THEY ARE SPECIFICALLY SHOWN ON THE DRAWINGS.
- LIP OF ALL KERB RADI ARE 8.60m UNLESS OTHERWISE SHOWN.
- FOOTPATHS TO BE OFFSET 50mm FROM THE TITLE BOUNDARIES.
- VEHICULAR CROSSINGS OF THE TYPE INDICATED ARE TO BE OFFSET 0.75m FROM THE LOT BOUNDARY OR EASEMENT UNLESS OTHERWISE SHOWN. DRIVEWAY GRADES INTO ALLOTMENTS TO BE 1 IN 6 MAX. DRIVEWAY LAYBACK AND WINGS SHALL BE CONSTRUCTED AS A SINGLE SEGMENT OF CONCRETE.

- PROVIDE LAYBACKS IN KERB TO ALL PRAM CROSSINGS IN ACCORDANCE WITH COUNCIL STANDARDS. ASPHALT FILLETS/STAMPS ARE TO BE PROVIDED ON THE BASE COURSE ASPHALT TO REMOVE TRIPS AT ALL PEDESTRIAN CROSSING LOCATIONS.
- ALL LINE MARKING AND SIGNAGE TO BE INSTALLED IN ACCORDANCE WITH AS 1742-1 AND AS 1742-2, UNLESS SPECIFICALLY SHOWN OTHERWISE. LINEMARKING IS TO BE INSTALLED USING EXTRUDED LONG LIFE THERMOPLASTIC PAINT. TEMPORARY LINEMARKING USING ORDINARY PAINT IS TO BE APPLIED WHEN WEARING COURSE ASPHALT IS NOT APPLIED FOR A PERIOD OF TIME E.G. AT PRACTICAL COMPLETION. STREET SIGNS ARE REQUIRED TO SHOW STREET NUMBERS APPLICABLE TO EACH BLOCK. ALL TEMPORARY WARNING SIGNS USED DURING CONSTRUCTION SHALL BE IN ACCORDANCE WITH AS 1742-3.
- THE LOCATION OF EXISTING SERVICES SHOWN ON THESE PLANS SHALL BE PROVEN ON SITE. THE APPROPRIATE AUTHORITY SHALL BE CONTACTED AND THE SERVICES LOCATED PRIOR TO COMMENCEMENT OF CONSTRUCTION.
- ALL EASEMENTS ARE 2.0m OR 3.0m WIDE DRAINAGE AND SEWERAGE EASEMENTS UNLESS OTHERWISE SHOWN.
- CENTRELINES OF ALL SEWERS ARE OFFSET 1.2m OR 2.0m FROM THE PROPERTY LINE UNLESS OTHERWISE SHOWN.
- CENTRELINES OF ALL EASEMENT DRAINS ARE OFFSET 1.0m OR 2.2m FROM THE PROPERTY LINE UNLESS OTHERWISE SHOWN.
- ALL STORMWATER DRAINS ARE TO BE CLASS '2' RC PIPES UNLESS OTHERWISE SHOWN. ALL RC PIPES ARE TO BE RUBBER RING JOINTED (RRJ).
- WHERE CURVED PIPES ARE SHOWN ON THE FACE PLANS THEY ARE TO BE LAID PARALLEL TO THE BACK OF KERB, EXCEPT WHERE A RADIUS HAS BEEN SPECIFICALLY NOMINATED. ALL DRAINS BEHIND KERBS ARE TO BE LAID AT THE OFFSET SPECIFIED IN THE COUNCIL SPECIFICATION. CURVED PIPES OF DIAMETER LESS THAN 600mm ON LARGE RADIUS CURVES ARE APPROVED BY COUNCIL SUBJECT TO COMPLIANCE WITH MANUFACTURER'S SPECIFICATION.
- ALL PIPE AND SERVICE TRENCHES THAT EXTEND UNDER ROADWAYS TO BE BACKFILLED WITH CLASS 2 CRUSHED ROCK. ALL SERVICE TRENCHES UNDER DRIVEWAYS, FOOTPATHS AND PARKING BAYS TO BE BACKFILLED WITH CLASS 2 CRUSHED ROCK. SERVICE TRENCHES LESS THAN 750mm BEHIND PARKING BAYS ARE ALSO TO BE BACKFILLED WITH COMPACTED CLASS 2 CRUSHED ROCK.
- 100mm NOMINAL DIAMETER P.V.C. CLASS 400 A.G. DRAIN TO BE LAID BEHIND ALL KERB & CHANNEL AS SHOWN ON THE TYPICAL SECTION.
- PROPERTY INLETS ARE TO BE PLACED 1.0m FROM LOW CORNERS OF ALLOTMENTS UNLESS OTHERWISE SHOWN.
- 100mm DIA. HOUSE DRAINS IN STREETS TO BE PLACED 5.5m FROM LOW CORNERS AS PER GAA FIGURE 016 UNLESS OTHERWISE SHOWN.
- POSITION CONDUITS SO THAT A MINIMUM DISTANCE BETWEEN TAPPINGS IS 1.0m. CONDUITS NOT TO BE LOCATED WITHIN 4.0m OF ALLOTMENT BOUNDARY, UNLESS OTHERWISE SHOWN.
- WATER TAPPINGS FOR LOTS SITUATED ON THE SAME SIDE AS THE WATERMAIN ARE TO BE LOCATED AT THE CENTRE OF THE LOT. THE KERB IS TO BE MARKED "W" WITH AN ARROW POINTING TO THE TAPPING.
- GAS & WATER CONDUITS ARE TO BE 100mm DIA. CLASS 12 P.V.C. LAID AT A MINIMUM DEPTH OF 815mm BELOW TOP OF KERB AND LOCATED IN THE POSITIONS SHOWN. THEY ARE TO BE PLACED AT RIGHT ANGLES TO THE KERB AND SERVICE ALIGNMENT AND ARE TO EXTEND TO THE PROPERTY BOUNDARY. CONDUITS ARE TO BE REFERENCED IN 50mm HIGH LETTERS ON THE FACE OF KERB AND CHANNEL.
- ELECTRICITY CONDUITS ARE TO BE LAID WITH THE FOLLOWING MINIMUM COVER TO FINISHED SURFACE LEVELS : UNDER ROADS - 0.90m ELSEWHERE - 0.60m
- ANY LINE MARKING REQUIRED AS PART OF THE CONSTRUCTION PLANS, MUST BE APPLIED TO THE INTERIM ASPHALTS LAYER, AS WELL AS THE WEARING COURSE LAYER.
- ALL PAVEMENT MATERIALS ARE TO BE VICROADS APPROVED MATERIALS
- PRIOR TO THE ISSUE OF A STATEMENT OF COMPLIANCE, ALL DRAINS ARE TO BE CCTV TESTED AND THE RESULTS PROVIDED TO COUNCIL.
- NO TOPSOIL IS TO BE REMOVED FROM SITE WITHOUT THE APPROVAL OF COUNCIL.
- NBN PITS SHALL BE CONSTRUCTED CLEAR OF FOOTPATHS.
- STREET NUMBERS TO BE STENCILLED ON THE FACE OF KERB IN 100mm HIGH YELLOW NUMERALS
- APPROPRIATE SILTATION CONTROL IS TO BE CARRIED OUT DURING CONSTRUCTION AND MAINTENANCE PERIOD
- HAZARD/DIRECTIONAL TGS'S AND PRAM CROSSINGS SHALL BE CONSTRUCTED IN ACCORDANCE WITH STANDARD DRAWINGS AND AS1428.4
- PSM SKETCH PLANS ARE TO BE PREPARED ESTABLISHING A.H.D LEVELS AND A.M.G CO-ORDINATES FOR REGISTRATION BY A LICENSED SURVEYOR
- SUBSURFACE DRAINS ARE TO BE LAID BEHIND ALL KERB AND CHANNEL AS PER EDM 202

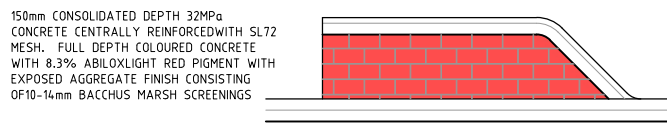

PARKING BAY TREATMENT
SCALE 1:100

THRESHOLD PAVEMENT
SCALE 1:100

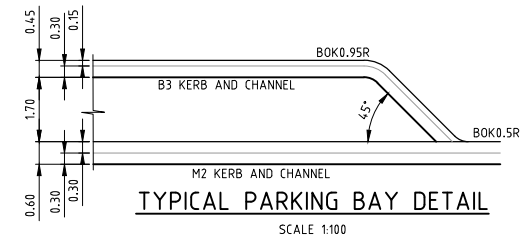

TYPICAL PARKING BAY DETAIL
SCALE 1:100

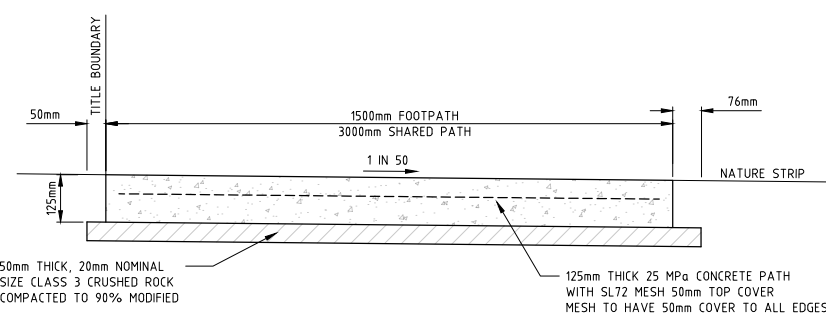

TYPICAL SECTION FOOTPATH
SCALE 1:20

REFER TO VPA EDM STANDARD DRG 401

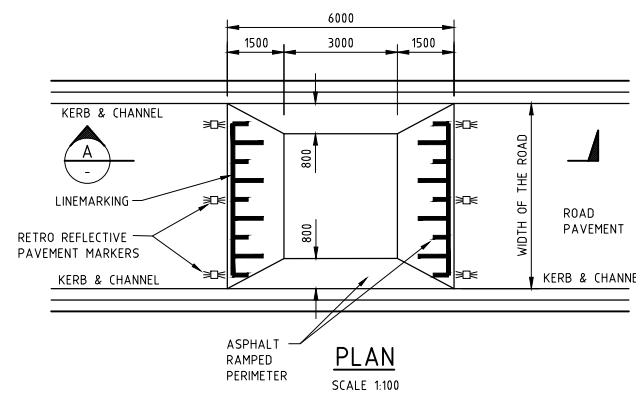

SPEED HUMP DETAIL
SCALE 1:100

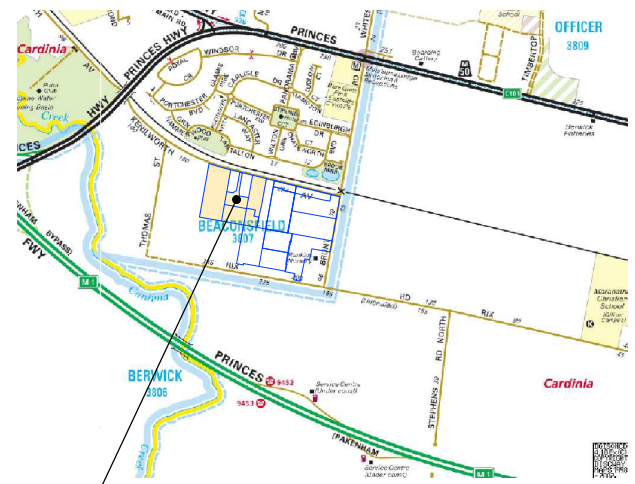

LOCALITY PLAN
SCALE: NOT TO SCALE
MELWAYS: 214 C5

DRAWING INDEX		
SHEET No.	DRAWING No.	DESCRIPTION
01	18144FTD01	NOTES, LOCALITY PLAN, TYPICAL DETAILS AND DRAWING INDEX
02-03	18144FD02-03	TYPICAL SECTIONS, SHEETS 01 TO 02
04	18144FSP01	STAGING PLAN
05-06	18144FDP01-02	DETAIL PLAN, SHEETS 01 TO 02
07-08	18144FPB01-02	ONSTREET PARKING PLAN, SHEETS 01 TO 02
09-10	18144FDI01-02	INTERSECTION DETAILS, SHEET 01 TO 02
11-16	18144FTT01-06	TURNING PATH PLAN, SHEETS 01 TO 06

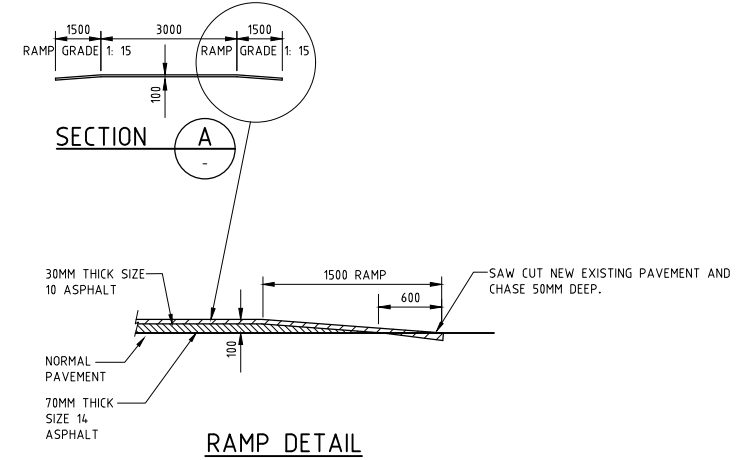

RAMP DETAIL

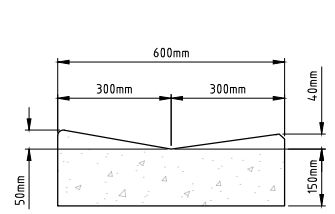

M2 MOUNTABLE KERB
SCALE 1:10

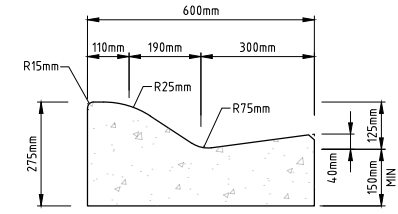

SM2 KERB & CHANNEL
SCALE 1:10

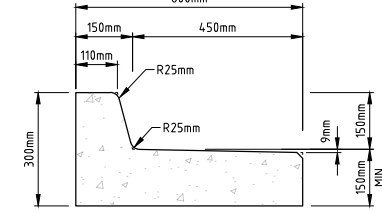

B3 KERB & CHANNEL
SCALE 1:10

FUNCTIONAL LAYOUT PLAN APPROVAL
CARDINIA SHIRE COUNCIL

Ref No.: T170521 - Stages 1,2,3
Sheet: 2 of 17
Approved by: Justin Conn
CARDINIA SHIRE COUNCIL
Date: Friday, 5 June 2020

REV	DESCRIPTION	DATE	AMEND	APPD
E	STAGES 4,5,6 SHOWN AS FUTURE WORKS	02/06/20	CB	TL
D	COUNCIL COMMENTS (27/04/20)	12/05/20	CB/PB	TL
C	COUNCIL COMMENTS ADDRESSED	03/04/20	CB	TL
B	COUNCIL COMMENTS ADDRESSED	21/11/19	CB	TL
A	COUNCIL ISSUE	10/09/19	BA	TL

Drawn: B.ADAMS
Date: 26/04/19
AN: 2591040
Designed: C.BLISSETT
Date: 26/04/19
AN: 2771009
Verified: AN
Date: AN
Approved: AN
Date: AN

© Dalton Consulting Engineers Pty Ltd



Scale @ A1/A3 AS SHOWN

BEACONSFIELD WATTLE ESTATE
CARDINIA SHIRE COUNCIL
STAGE 1-6
190 KENILWORTH AVENUE, BEACONSFIELD
NOTES, LOCALITY PLAN,
TYPICAL DETAILS AND DRAWING INDEX
Drawing No. 18144FTD01 Rev E
Sheet No. 01 of 16

DALTON CONSULTING ENGINEERS
ABN 78 429 221 049
VICTORIA
T 61 3 9813 7400
W dceng.com.au
QUEENSLAND
T 61 7 3374 9000
E info@dceng.com.au

FUNCTIONAL

Drawing File: C:\126_Sydney\data\SYNERGY-ME\18144-Beaconsfield Wattle Estate_1073\1_LDESIGN\01_ACAD\03_GENERAL\FUNCTIONAL PLANS\18144FTD01.dwg - 18144FTD01.dwg
Date/Time: Tue Jun 02, 2020 - 4:56pm - ccsales

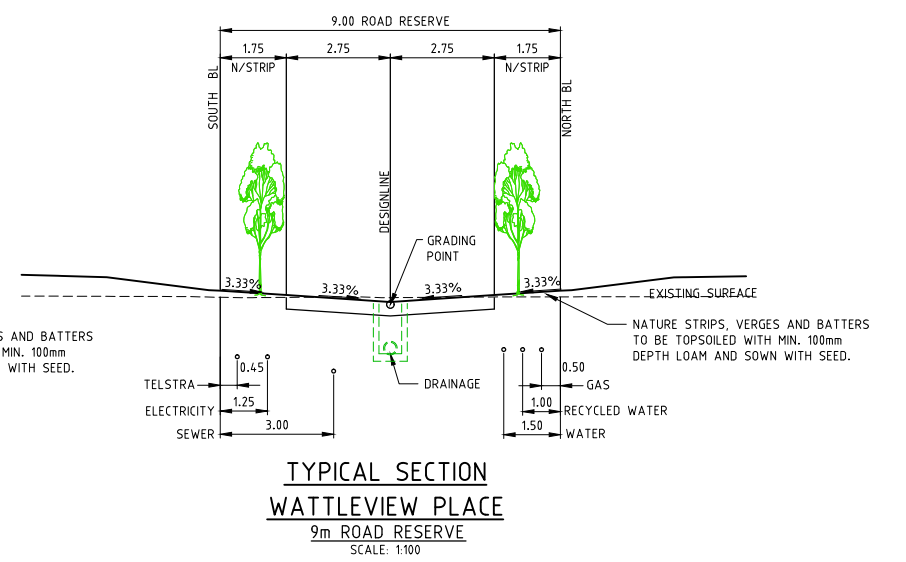
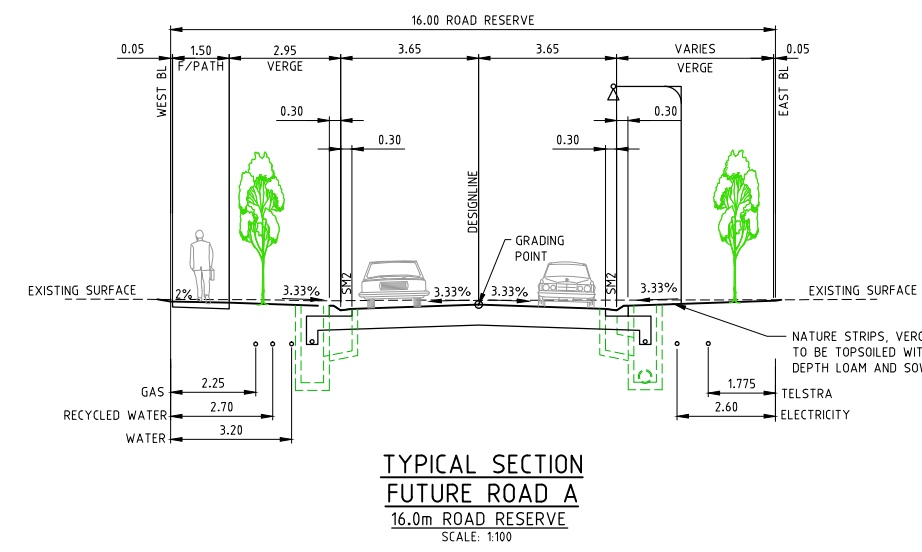
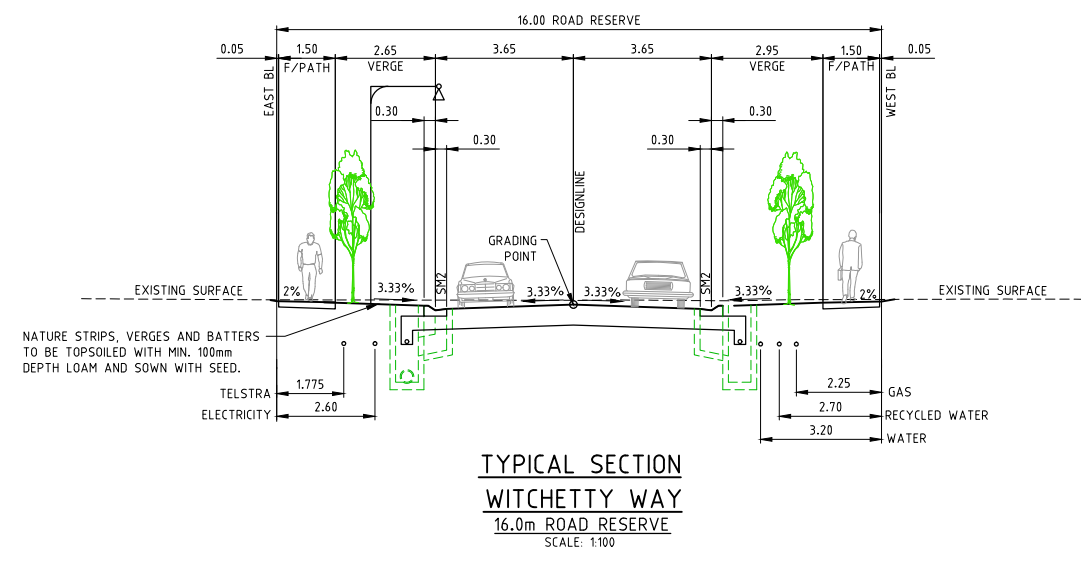
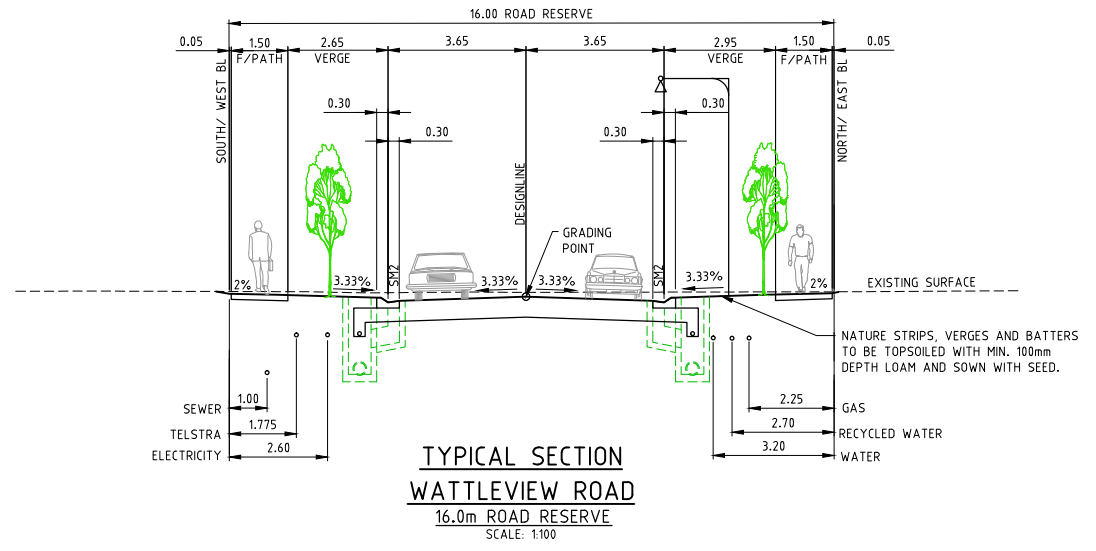
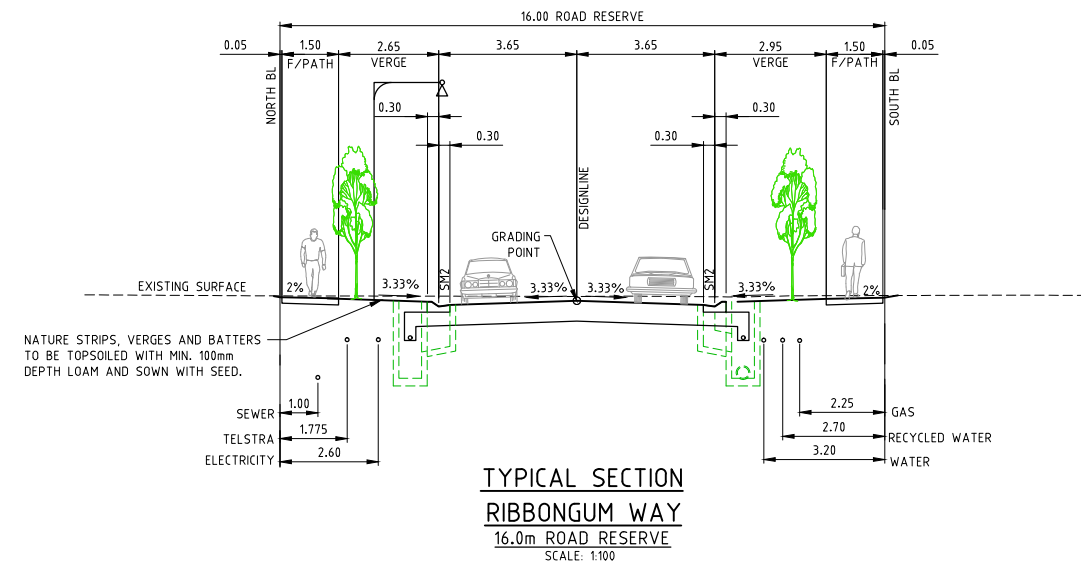

FUNCTIONAL LAYOUT PLAN APPROVAL

CARDINIA SHIRE COUNCIL

Ref No.: T170521 - Stages 1,2,3
 Sheet: 3 of 17
 Approved by: Justin Conn
CARDINIA SHIRE COUNCIL
 Date: Friday, 5 June 2020

TABLE OF SERVICES LOCATIONS

STREET NAME	WATER	ND WATER	GAS	TELECOM	ELEC.	SEWER	BOX
ICEBERG ROAD	3.80 W	3.30 W	2.80 W	2.80 E	3.30 E	1.00 W	6.40 W 5.70 E
WATTLEVIEW ROAD	3.20 N/E	2.70 N/E	2.25 N/E	1.775 S/W	2.60 S/W	1.00 S/W	3.90S/W 4.20N/E
WITCHETTY WAY	3.20 W	2.70 W	2.25 W	1.775 E	2.60 E	-	4.20 W 3.90 E
RIBBONBUM WAY	3.20 S	2.70 S	2.25 S	1.1775 N	2.60 N	1.00 N	4.20 S 3.90 N
ROAD A	3.20 W	2.70 W	2.25 W	1.775 E	2.60 E	-	4.20W/VARIES E
WATTLEVIEW PLACE	1.50 N	1.00 N	0.50 N	0.45 S	1.25 S	3.00 S	-

Drawing File: C:\126_Sydney\data\SYNERGY-ME\18144-Beaconsfield Wattle Estate_1073\DESIGN\01_18144-General\FUNCTIONAL PLANS\18144FTD01.dwg - 18/11/2020 - 4:56pm - ccs@dceng.com.au
 Written dimensions to take precedence over scale. Contractor shall check and verify all dimensions on site. Discrepancies to be brought to the attention of the Superintendent.

REV	DESCRIPTION	DATE	AMEND	APPD
E	STAGES 4,5,6 SHOWN AS FUTURE WORKS	02/06/20	CB	TL
D	COUNCIL COMMENTS (27/04/20)	12/05/20	CB/PB	TL
C	COUNCIL COMMENTS ADDRESSED	03/04/20	CB	TL
B	COUNCIL COMMENTS ADDRESSED	21/11/19	CB	TL
A	COUNCIL ISSUE	10/09/19	BA	TL

Drawn: B.ADAMS
 Date: 26/04/19
 AN: 2591040
 Designed: C.BLISSETT
 Date: 26/04/19
 AN: 2771009
 Verified: AN
 Date: AN
 Approved: BA
 Date: AN

© Dalton Consulting Engineers Pty Ltd

BANRIAR INVESTMENTS

Coords: MGA Levels: AHD

DIAL BEFORE YOU DIG
www.1100.com.au

Scale @ A1/A3 1:100 / 1:200

BEAONSFIELD WATTLE ESTATE
CARDINIA SHIRE COUNCIL
 STAGE 1-6
 190 KENILWORTH AVENUE, BEAONSFIELD
TYPICAL SECTIONS
 SHEET 01 OF 02
 Drawing No. 18144FTD02 Rev E
 Sheet No. 02 of 16

DALTON CONSULTING ENGINEERS
 ABN 78 429 221 049
 VICTORIA T 61 3 9813 7400 W dceng.com.au
 QUEENSLAND T 61 7 3374 9000 E info@dceng.com.au

FUNCTIONAL

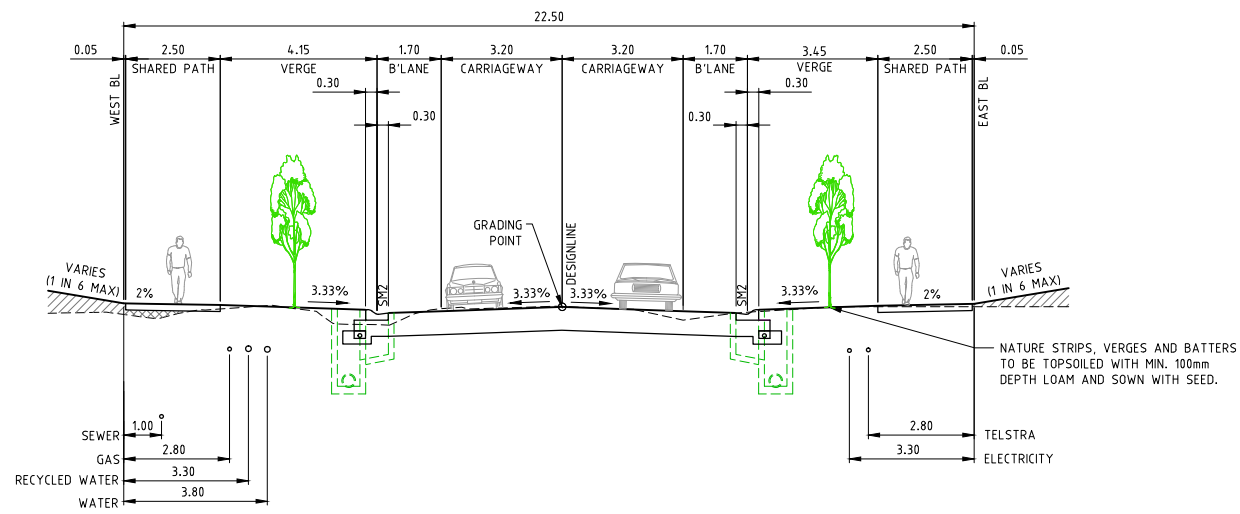

TYPICAL SECTION
ICEBERG ROAD
 22.50m ROAD RESERVE
 SCALE: 1:100

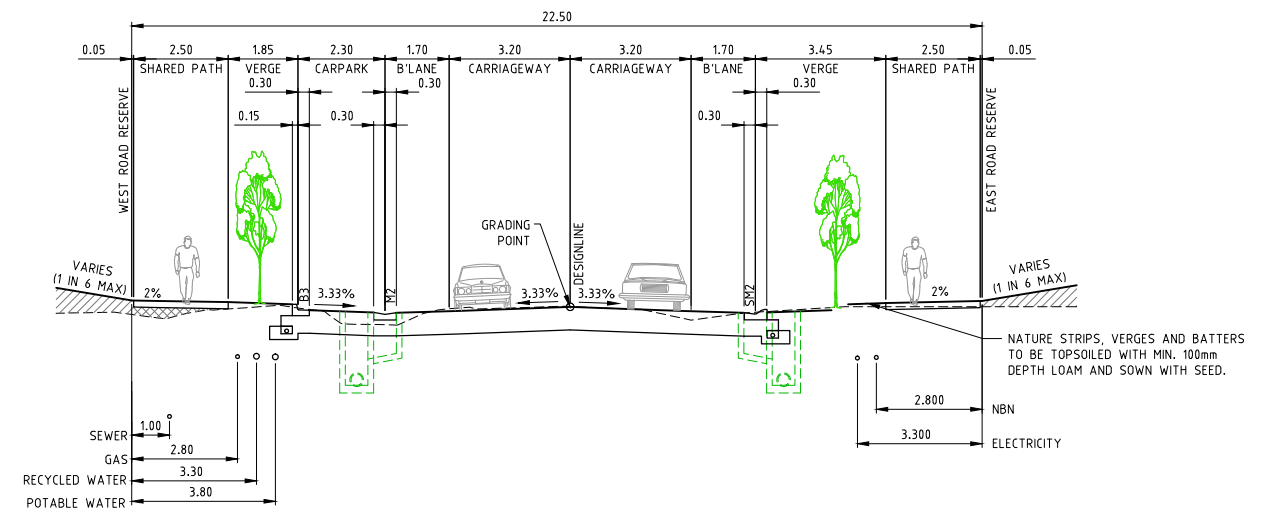

TYPICAL SECTION
ICEBERG ROAD (WITH INDENTED CAR PARK)
 22.50m ROAD RESERVE
 SCALE: 1:100

FUNCTIONAL LAYOUT PLAN APPROVAL
CARDINIA SHIRE COUNCIL
 Ref No.: T170521 - Stages 1,2,3
 Sheet: 4 of 17
 Approved by: Justin Conn
CARDINIA SHIRE COUNCIL
 Date: Friday, 5 June 2020

TABLE OF SERVICES LOCATIONS

STREET NAME	WATER	ND WATER	GAS	TELECOM	ELEC.	SEWER	BOK
ICEBERG ROAD	3.80 W	3.30 W	2.80 W	2.80 E	3.30 E	1.00 W	6.40 W 5.70 E
WATTLEVIEW ROAD	3.20 N/E	2.70 N/E	2.25 N/E	1.775 S/W	2.60 S/W	1.00 S/W	3.90S/W 4.20N/E
WITCHETTY WAY	3.20 W	2.70 W	2.25 W	1.775 E	2.60 E	-	4.20 W 3.90 E
RIBBONBUM WAY	3.20 S	2.70 S	2.25 S	1.1775 N	2.60 N	1.00 N	4.20 S 3.90 N
ROAD A	3.20 W	2.70 W	2.25 W	1.775 E	2.60 E	-	4.20W/VARIES E
WATTLEVIEW PLACE	1.50 N	1.00 N	0.50 N	0.45 S	1.25 S	3.00 S	-

NOT TO BE USED FOR CONSTRUCTION

REV	DESCRIPTION	DATE	AMEND	APP'D
E	STAGES 4,5,6 SHOWN AS FUTURE WORKS	02/06/20	CB	TL
D	COUNCIL COMMENTS (27/04/20)	12/05/20	CB/PB	TL
C	COUNCIL COMMENTS ADDRESSED	03/04/20	CB	TL
B	COUNCIL COMMENTS ADDRESSED	21/11/19	CB	TL
A	COUNCIL ISSUE	10/09/19	BA	TL

Drawn: B.ADAMS
 Date: 26/04/19
 AN 2591040
 Designed: C.BLISSETT
 Date: 26/04/19
 AN 2771009
 Verified: AN
 Date: AN
 Approved: AN
 Date: AN

© Dalton Consulting Engineers Pty Ltd



Scale @ A1/A3 1:100 / 1:200

BEACONSFIELD WATTLE ESTATE
CARDINIA SHIRE COUNCIL
 STAGE 1-6
 190 KENILWORTH AVENUE, BEACONSFIELD
TYPICAL SECTIONS
 SHEET 02 OF 02
 Drawing No. 18144FTD03 Rev E



FUNCTIONAL

Drawing File: C:\126_Sydney\data\SYNERGY-HE\18144-General\FUNCTIONAL PLANS\18144FTD03.dwg - 18144FTD03
 Date/Time: Tue Jun 02, 2020 - 4:56pm - ccsksh

FUNCTIONAL LAYOUT PLAN APPROVAL
CARDINIA SHIRE COUNCIL
 Ref No.: T170521 - Stages 1,2,3
 Sheet: 5 of 17
 Approved by: Justin Conn
CARDINIA SHIRE COUNCIL
 Date: Friday, 5 June 2020

FOR DETAILS REFER SHEET 06

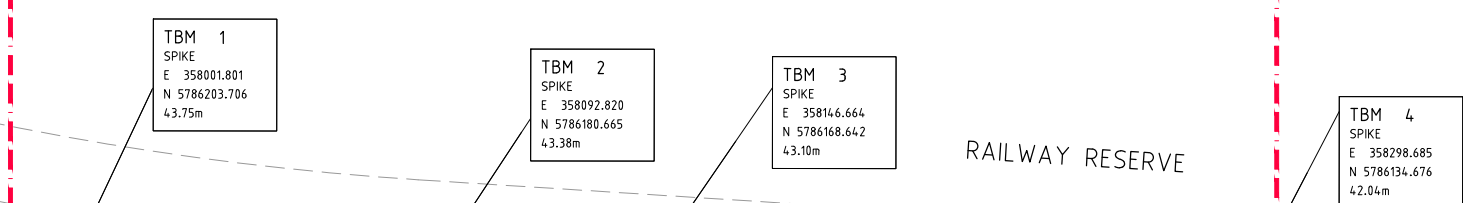

FOR DETAILS REFER SHEET 05

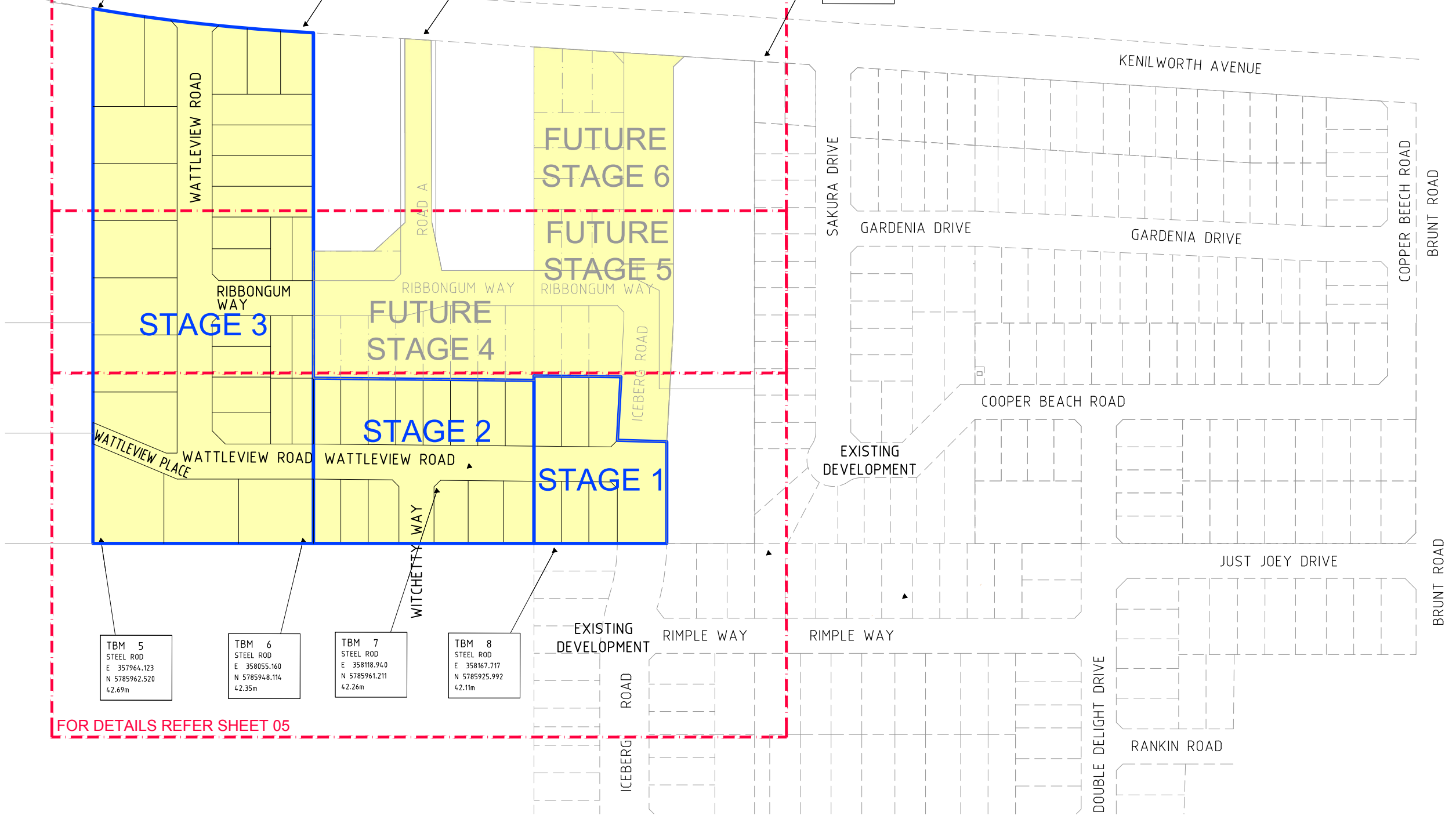

Drawing File: C:\126_Sydney\data\SYNERGY-HE\18144-Beaconsfield Wattle Estate_1073\LD\DESIGN\01_ACAD\03_GENERAL\FUNCTIONAL PLANS\18144\FSP01.dwg - 18144\FSP01.dwg
 Date/Time: Tue Jun 02, 2020 - 4:56pm - ccs@dceng.com.au

REV	DESCRIPTION	DATE	AMEND	APPD
E	STAGES 4,5,6 SHOWN AS FUTURE WORKS	02/06/20	CB	TL
D	COUNCIL COMMENTS (27/04/20)	12/05/20	CB/PB	TL
C	COUNCIL COMMENTS ADDRESSED	03/04/20	CB	TL
B	COUNCIL COMMENTS ADDRESSED	21/11/19	CB	TL
A	COUNCIL ISSUE	10/09/19	BA	TL

Drawn: B.ADAMS
 Date: 26/04/19
 AN 2591040
 Designed: C.BUSSETT
 Date: 26/04/19
 AN 2771009
 Verified: AN
 Date: AN
 Approved: BA
 Date: AN

© Dalton Consulting Engineers Pty Ltd



Scale @ A1/A3 1:1000 / 1:2000

BEAconsfield WATTLE ESTATE
CARDINIA SHIRE COUNCIL
STAGE 1-6
 190 KENILWORTH AVENUE, BEAconsFIELD
STAGING PLAN

Drawing No. 18144FSP01 Rev E
 Sheet No. 04 of 16



FUNCTIONAL

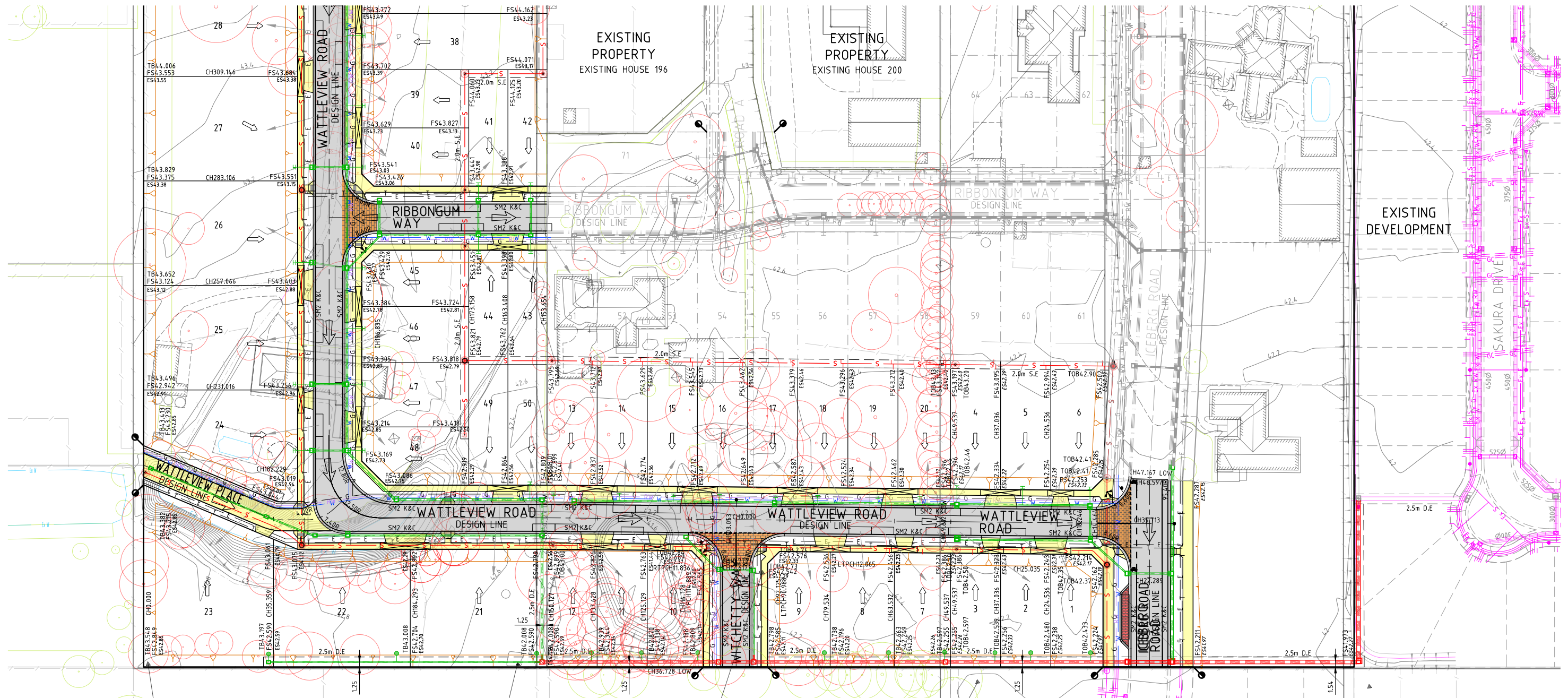

TBM 5
STEEL ROD
E 357964.123
N 5785962.520
42.69m

TBM 6
STEEL ROD
E 358055.160
N 5785948.114
42.35m

TBM 7
STEEL ROD
E 358118.940
N 5785961.211
42.26m

TBM 8
STEEL ROD
E 358167.717
N 5785925.992
42.11m

NOTE:
PRIOR TO APPROVE STAGES 4,5 & 6, FINAL ALIGNMENT OF ICEBERG ROAD MUST BE AGREED BETWEEN CARDINIA SHIRE COUNCIL, DEVELOPER AND RELEVANT LAND OWNERS

WARNING!
NO DRAINAGE WORKS SHALL COMMENCE UNTIL THE CONTRACTOR CONFIRMS THE I.L. OF ALL EXISTING DRAINS, AND CONFIRMS IN WRITING WITH THE ENGINEERING SUPERVISOR.

WARNING!
THE LOCATION OF EXISTING SERVICES SHOWN ON THESE PLANS MUST BE PROVEN ON SITE, THE APPROPRIATE AUTHORITY MUST BE CONTACTED AND THE SERVICES LOCATED PRIOR TO COMMENCEMENT OF ANY WORKS.

TABLE OF SERVICES LOCATIONS

STREET NAME	WATER	ND WATER	GAS	TELECOM	ELEC.	SEWER	BOK
ICEBERG ROAD	3.80 W	3.30 W	2.80 W	2.80 E	3.30 E	1.00 W	6.40 W 5.70 E
WATTLEVIEW ROAD	3.20 N/E	2.70 N/E	2.25 N/E	1.775 S/W	2.60 S/W	1.00 S/W	3.90S/W 4.20N/E
WITCHETTY WAY	3.20 W	2.70 W	2.25 W	1.775 E	2.60 E	-	4.20 W 3.90 E
RIBBONBUM WAY	3.20 S	2.70 S	2.25 S	1.1775 N	2.60 N	1.00 N	4.20 S 3.90 N
ROAD A	3.20 W	2.70 W	2.25 W	1.775 E	2.60 E	-	4.20W/VARIES E
WATTLEVIEW PLACE	1.50 N	1.00 N	0.50 N	0.45 S	1.25 S	3.00 S	-

FUNCTIONAL LAYOUT PLAN APPROVAL
CARDINIA SHIRE COUNCIL
Ref No.: T170521 - Stages 1,2,3
Sheet: 6 of 17
Approved by: Justin Conn
CARDINIA SHIRE COUNCIL
Date: Friday, 5 June 2020

NOT TO BE USED FOR CONSTRUCTION

REV	DESCRIPTION	DATE	AMEND	APPD
E	STAGES 4,5,6 SHOWN AS FUTURE WORKS	02/06/20	CB	TL
D	COUNCIL COMMENTS (27/04/20)	12/05/20	CB/PB	TL
C	COUNCIL COMMENTS ADDRESSED	03/04/20	CB	TL
B	COUNCIL COMMENTS ADDRESSED	21/11/19	CB	TL
A	COUNCIL ISSUE	10/09/19	BA	TL

Drawn: B.ADAMS
Date: 26/04/19
AN 2591040
Designed: C.BLISSETT
Date: 26/04/19
AN 2771009
Verified: [Signature]
Date: [Signature]
Approved: [Signature]
Date: [Signature]
AN

LEGEND

- EX-W WATER MAIN
- EX-G GAS MAIN
- EX-E ELECTRICAL CABLE
- EX-S-O EX. SEWER MAIN & MH
- EX-T EX. COMPL. CABLE & PIT
- EX-V-V EX. ELEC. O/H LINES
- EX-D EX. DRAIN & PIT
- G GAS
- W WATER
- RW RECYCLED WATER
- E ELECTRICITY
- T TELECOMMUNICATIONS
- G FUTURE GAS
- W FUTURE WATER
- RW FUTURE RECYCLED WATER
- E FUTURE ELECTRICITY
- T FUTURE TELECOMMUNICATIONS
- S SEWER MAIN & MANHOLE
- FUTURE SEWER MAIN & MANHOLE
- SW SW DRAIN & PIT
- HW HW DRAIN & PIT
- SW SW DRAIN & PIT
- HW HW DRAIN & PIT
- PROPERTY INLETS
- H HOUSE DRAIN
- PSM / TBM
- ES20.06 EX. SURFACE LEVEL
- FS21.650 FINISHED SURFACE LEVEL
- ASPHALT PAVEMENT
- CONCRETE PATH / DWAY
- THRESHOLD PAVEMENT
- PARKING BAY TREATMENT
- EX. TREE TO BE REMOVED
- OVERLAND FLOW PATH

BANRIAR INVESTMENTS

Coords: MGA Levels: AHD

DIAL BEFORE YOU DIG
www.1100.com.au

Scale @ A1/A3 1:500 / 1:1000

BEACONSFIELD WATTLE ESTATE
CARDINIA SHIRE COUNCIL
STAGE 1-6
190 KENILWORTH AVENUE, BEACONSFIELD
DETAIL PLAN
SHEET 01 OF 02
Drawing No. 18144FDP01 Rev E
Sheet No. 05 of 16

DALTON CONSULTING ENGINEERS
ABN 78 429 221 049
VICTORIA T 61 3 9813 7400
W dceng.com.au
QUEENSLAND T 61 7 3374 9000
E info@dceng.com.au

FUNCTIONAL

Drawing File: C:\126_Sydney\18144-FDP01\18144-Beaconsfield Wattle Estate_1073\1_LDESIGN\01_ACAD\03_GENERAL\FUNCTIONAL PLANS\18144FDP01.dwg - 18144FDP01
Date/Time: Tue Jun 02, 2020 - 4:56pm - ccsk@dc

NOTE:
PRIOR TO APPROVE STAGES 4,5 & 6, FINAL ALIGNMENT OF ICEBERG ROAD MUST BE AGREED BETWEEN CARDINIA SHIRE COUNCIL, DEVELOPER AND RELEVANT LAND OWNERS

FUNCTIONAL LAYOUT PLAN APPROVAL
CARDINIA SHIRE COUNCIL
Ref No.: T170521 - Stages 1,2,3
Sheet: 7 of 17
Approved by: Justin Conn
CARDINIA SHIRE COUNCIL
Date: Friday, 5 June 2020

STREET NAME	WATER	ND WATER	GAS	TELECOM	ELEC.	SEWER	BOK
ICEBERG ROAD	3.80 W	3.30 W	2.80 W	2.80 E	3.30 E	1.00 W	6.40 W 5.70 E
WATTLEVIEW ROAD	3.20 N/E	2.70 N/E	2.25 N/E	1.775 S/W	2.60 S/W	1.00 S/W	3.90S/W 4.20N/E
WITCHETTY WAY	3.20 W	2.70 W	2.25 W	1.775 E	2.60 E	-	4.20 W 3.90 E
RIBBONBUM WAY	3.20 S	2.70 S	2.25 S	1.775 N	2.60 N	1.00 N	4.20 S 3.90 N
ROAD A	3.20 W	2.70 W	2.25 W	1.775 E	2.60 E	-	4.20W/VARIES E
WATTLEVIEW PLACE	1.50 N	1.00 N	0.50 N	0.45 S	1.25 S	3.00 S	-

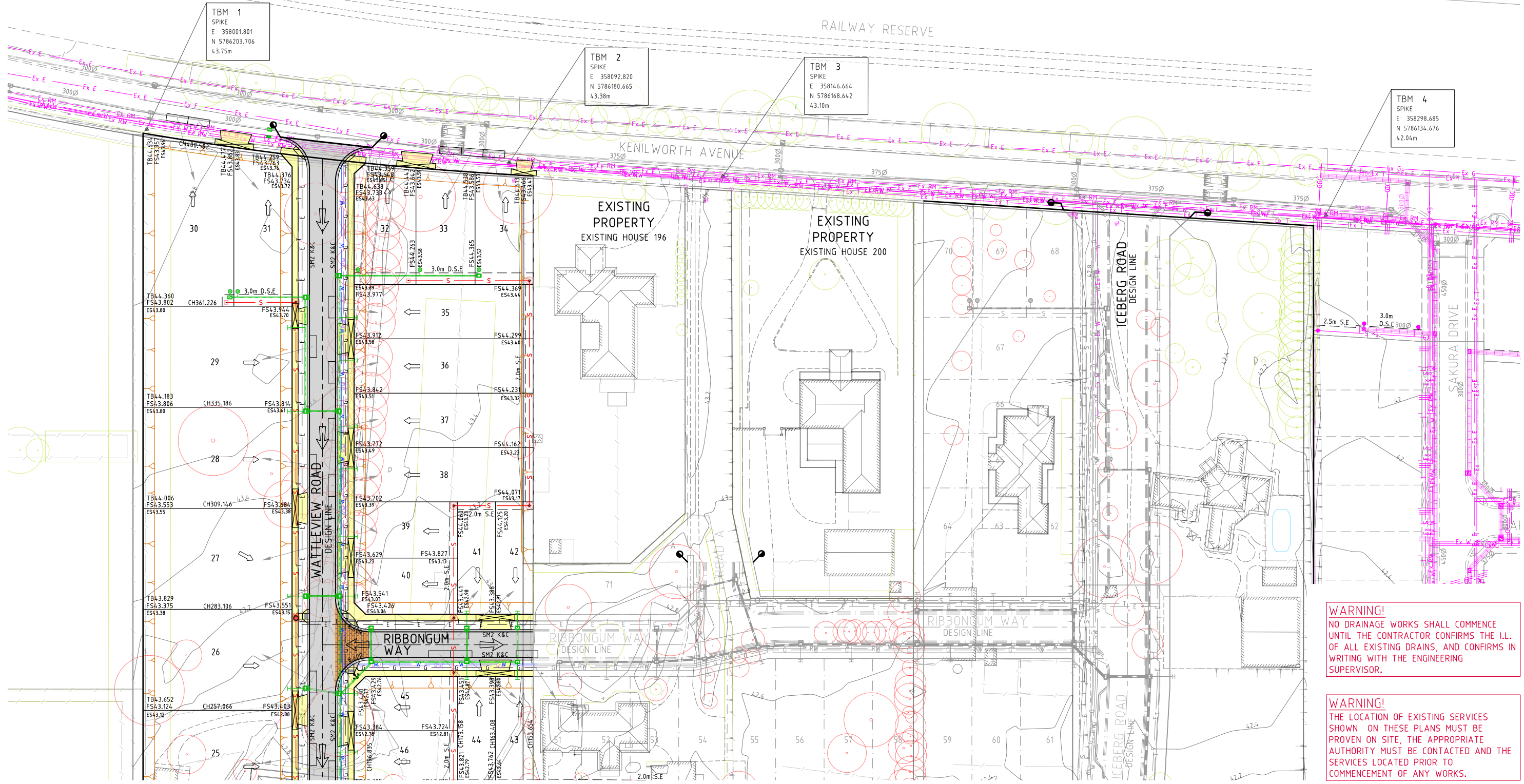

WARNING!
NO DRAINAGE WORKS SHALL COMMENCE UNTIL THE CONTRACTOR CONFIRMS THE I.L. OF ALL EXISTING DRAINS, AND CONFIRMS IN WRITING WITH THE ENGINEERING SUPERVISOR.

WARNING!
THE LOCATION OF EXISTING SERVICES SHOWN ON THESE PLANS MUST BE PROVEN ON SITE, THE APPROPRIATE AUTHORITY MUST BE CONTACTED AND THE SERVICES LOCATED PRIOR TO COMMENCEMENT OF ANY WORKS.

FOR CONTINUATION REFER SHEET 05

Drawing File: C:\126_Sydney\data\SYNERGY-ME\18144-Beaconsfield Wattle Estate_1073\1_LDESIGN\01_ACAD\03_GENERAL\FUNCTIONAL PLANS\18144FDP01.dwg - 18144FDP02 Date/Time: Tue Jun 02, 2020 - 4:56pm - ccsk@csd.com

REV	DESCRIPTION	DATE	AMEND	APPD
E	STAGES 4,5,6 SHOWN AS FUTURE WORKS	02/06/20	CB	TL
D	COUNCIL COMMENTS ADDRESSED (27/04/20)	12/05/20	CB/PB	TL
C	COUNCIL COMMENTS ADDRESSED	03/04/20	CB	TL
B	COUNCIL COMMENTS ADDRESSED	21/11/19	CB	TL
A	COUNCIL ISSUE	10/09/19	BA	TL

Drawn By: B.ADAMS
Date: 26/04/19
AN 2591040
Designed By: C.BLISSETT
Date: 26/04/19
AN 2771009
Verified Date: AN
Approved Date: AN
Date: 10/09/19
Date: 10/09/19

LEGEND

Ex W	EX. WATER MAIN	RW	RECYCLED WATER	ES20.06	EX. SURFACE LEVEL
Ex G	EX. GAS MAIN	E	ELECTRICITY	FS21.650	FINISHED SURFACE LEVEL
Ex E	EX. ELECTRICAL CABLE	T	TELECOMMUNICATIONS		ASPHALT PAVEMENT
Ex S	EX. SEWER MAIN & MH	G	FUTURE GAS		CONCRETE PATH / DWAY
Ex T	EX. COMPL. CABLE & PIT	W	FUTURE WATER		THRESHOLD PAVEMENT
Ex V	EX. ELEC. O/W LINES	FW	FUTURE RECYCLED WATER		PARKING BAY TREATMENT
Ex D	EX. DRAIN & PIT	P	FUTURE ELECTRICITY		EX. TREE TO BE REMOVED
G	GAS	H	HOUSE DRAIN		OVERLAND FLOW PATH
W	WATER	PSM	PSM / TBM		

Coords: MGA Levels: AHD

BANRIAR INVESTMENTS

Scale @ A1/A3 1:500 / 1:1000

BEAONSFIELD WATTLE ESTATE
CARDINIA SHIRE COUNCIL
STAGE 1-6
190 KENILWORTH AVENUE, BEAONSFIELD
DETAIL PLAN
SHEET 02 OF 02
Drawing No. 18144FDP02 Rev E
Sheet No. 06 of 16

DALTON CONSULTING ENGINEERS
ABN 78 429 221 049
VICTORIA T61 3 9813 7400 Wdceng.com.au
QUEENSLAND T61 7 3374 9000 E info@dceng.com.au

FUNCTIONAL



FUNCTIONAL LAYOUT PLAN APPROVAL
CARDINIA SHIRE COUNCIL
 Ref No.: T170521 - Stages 1,2,3
 Sheet: 8 of 17
 Approved by: Justin Conn
CARDINIA SHIRE COUNCIL
 Date: Friday, 5 June 2020

TABLE OF SERVICES LOCATIONS

STREET NAME	WATER	ND WATER	GAS	TELECOM	ELEC.	SEWER	BOX
ICEBERG ROAD	3.80 W	3.30 W	2.80 W	2.80 E	3.30 E	1.00 W	6.40 W 5.70 E
WATTLEVIEW ROAD	3.20 N/E	2.70 N/E	2.25 N/E	1.775 S/W	2.60 S/W	1.00 S/W	3.90S/W 4.20N/E
WITCHETTY WAY	3.20 W	2.70 W	2.25 W	1.775 E	2.60 E	-	4.20 W 3.90 E
RIBBONBUM WAY	3.20 S	2.70 S	2.25 S	1.1775 N	2.60 N	1.00 N	4.20 S 3.90 N
ROAD A	3.20 W	2.70 W	2.25 W	1.775 E	2.60 E	-	4.20W/VARIES E
WATTLEVIEW PLACE	1.50 N	1.00 N	0.50 N	0.45 S	1.25 S	3.00 S	-

WARNING!
 NO DRAINAGE WORKS SHALL COMMENCE UNTIL THE CONTRACTOR CONFIRMS THE I.L. OF ALL EXISTING DRAINS, AND CONFIRMS IN WRITING WITH THE ENGINEERING SUPERVISOR.

WARNING!
 THE LOCATION OF EXISTING SERVICES SHOWN ON THESE PLANS MUST BE PROVEN ON SITE, THE APPROPRIATE AUTHORITY MUST BE CONTACTED AND THE SERVICES LOCATED PRIOR TO COMMENCEMENT OF ANY WORKS.

NOT TO BE USED FOR CONSTRUCTION

REV	DESCRIPTION	DATE	AMEND	APPD
E	STAGES 4,5,6 SHOWN AS FUTURE WORKS	02/06/20	CB	TL
D	COUNCIL COMMENTS (27/04/20)	12/05/20	CB/PB	TL
C	COUNCIL COMMENTS ADDRESSED	03/04/20	CB	TL
B	COUNCIL COMMENTS ADDRESSED	21/11/19	CB	TL
A	COUNCIL ISSUE	10/09/19	BA	TL

Drawn: B.ADAMS
 Date: 26/04/19
 AN: 2591040
 Designed: C.BLISSETT
 Date: 26/04/19
 AN: 2771009
 Verified: AN
 Date: AN
 Approved: BA
 Date: AN

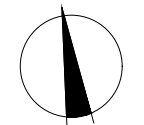

Scale @ A1/A3
 1:500 / 1:1000

BEACONSFIELD WATTLE ESTATE
CARDINIA SHIRE COUNCIL
STAGE 1-6
190 KENILWORTH AVENUE, BEACONSFIELD
ONSTREET PARKING PLAN
SHEET 01 OF 02
Drawing No. 18144FPB01 **Rev E**
 Sheet No. 07 of 16



FUNCTIONAL

Drawing File: C:\126_Sydney\data\SYNERGY-ME\18144-Beaconsfield Wattle Estate_1013\1_L103\01_03_GENERAL\FUNCTIONAL PLANS\18144FPB01.dwg - 18144FPB01.dwg
 Date/Time: Tue Jun 02, 2020 - 4:56pm - ccs@dalton.com.au

FUNCTIONAL LAYOUT PLAN APPROVAL
CARDINIA SHIRE COUNCIL
 Ref No.: T170521 - Stages 1,2,3
 Sheet: 9 of 17
 Approved by: Justin Conn
 CARDINIA SHIRE COUNCIL
 Date: Friday, 5 June 2020

TABLE OF SERVICES LOCATIONS							
STREET NAME	WATER	ND WATER	GAS	TELECOM	ELEC.	SEWER	BOK
ICEBERG ROAD	3.80 W	3.30 W	2.80 W	2.80 E	3.30 E	1.00 W	6.40 W 5.70 E
WATTLEVIEW ROAD	3.20 N/E	2.70 N/E	2.25 N/E	1.775 S/W	2.60 S/W	1.00 S/W	3.90S/W 4.20N/E
WITCHETTY WAY	3.20 W	2.70 W	2.25 W	1.775 E	2.60 E	-	4.20 W 3.90 E
RIBBONBUM WAY	3.20 S	2.70 S	2.25 S	1.1775 N	2.60 N	1.00 N	4.20 S 3.90 N
ROAD A	3.20 W	2.70 W	2.25 W	1.775 E	2.60 E	-	4.20W/VARIES E
WATTLEVIEW PLACE	1.50 N	1.00 N	0.50 N	0.45 S	1.25 S	3.00 S	-



WARNING!
 NO DRAINAGE WORKS SHALL COMMENCE UNTIL THE CONTRACTOR CONFIRMS THE I.L. OF ALL EXISTING DRAINS, AND CONFIRMS IN WRITING WITH THE ENGINEERING SUPERVISOR.

WARNING!
 THE LOCATION OF EXISTING SERVICES SHOWN ON THESE PLANS MUST BE PROVEN ON SITE, THE APPROPRIATE AUTHORITY MUST BE CONTACTED AND THE SERVICES LOCATED PRIOR TO COMMENCEMENT OF ANY WORKS.

FOR CONTINUATION REFER SHEET 07

Drawing File: C:\126_Sydney\data\SYNERGY-ME\18144-Beaconsfield Wattle Estate_1073\1_LDESIGN\01_ACAD\03_GENERAL\FUNCTIONAL PLANS\18144FPB02.dwg - 18144FPB02 - 4:56pm - 2020 - 4:56pm - ccs@dceng.com

REV	DESCRIPTION	DATE	AMEND	APPD
E	STAGES 4,5,6 SHOWN AS FUTURE WORKS	02/06/20	CB	TL
D	COUNCIL COMMENTS (27/04/20)	12/05/20	CB/PB	TL
C	COUNCIL COMMENTS ADDRESSED	03/04/20	CB	TL
B	COUNCIL COMMENTS ADDRESSED	21/11/19	CB	TL
A	COUNCIL ISSUE	10/09/19	BA	TL

Drawn Date: B.ADAMS 26/04/19
 AN 2591040
 Designed Date: C.BLISSETT 26/04/19
 AN 2771009
 Verified Date: AN
 Approved Date: AN
 © Dalton Consulting Engineers Pty Ltd

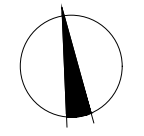

Scale @ A1/A3 1:500 / 1:1000

BEAONSFIELD WATTLE ESTATE
CARDINIA SHIRE COUNCIL
STAGE 1-6
190 KENILWORTH AVENUE, BEAONSFIELD
ONSTREET PARKING PLAN
SHEET 02 OF 02
Drawing No. 18144FPB02 Rev E
 Sheet No. 08 of 16

DALTON CONSULTING ENGINEERS
 ABN 78 429 221 049
 VICTORIA T 61 3 9813 7400 W dceng.com.au
 QUEENSLAND T 61 7 3374 9000 E info@dceng.com.au

FUNCTIONAL

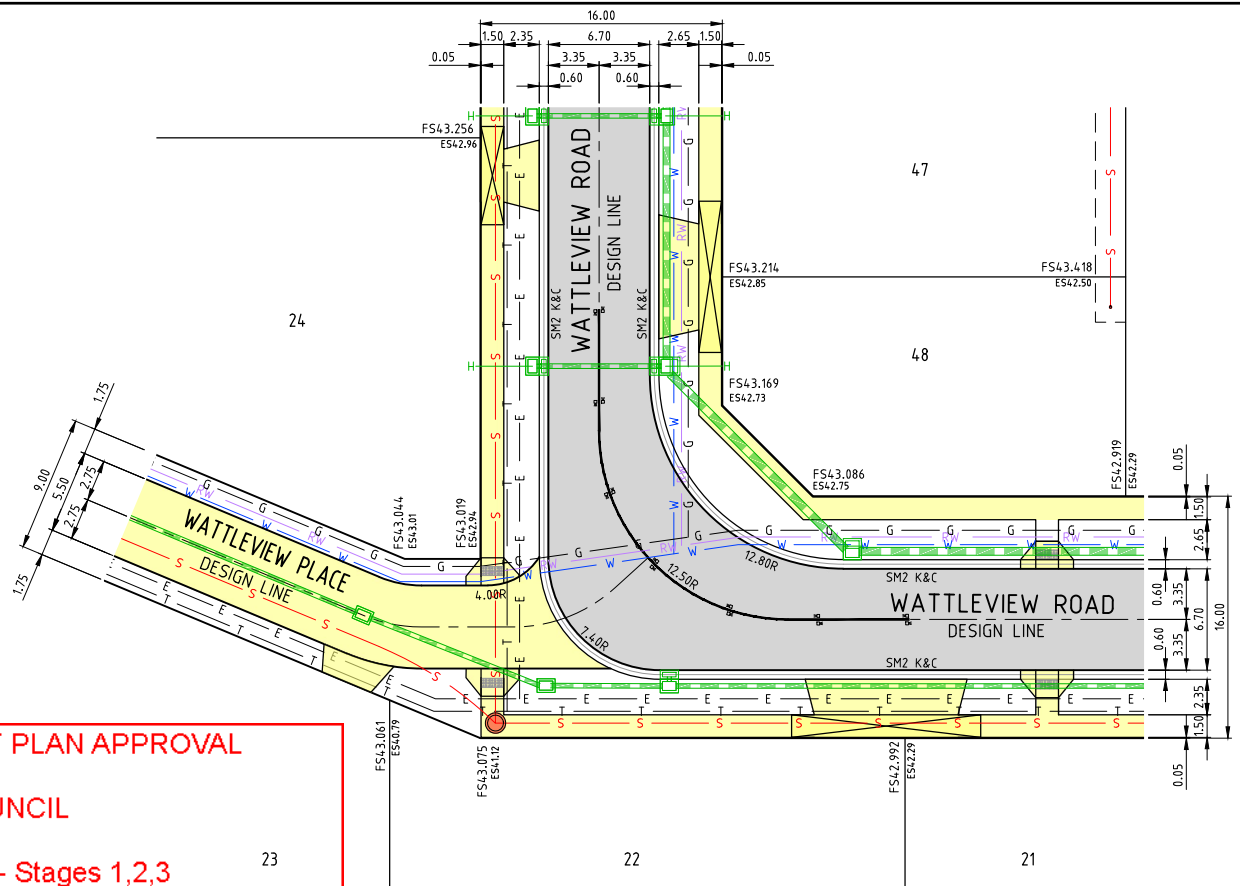
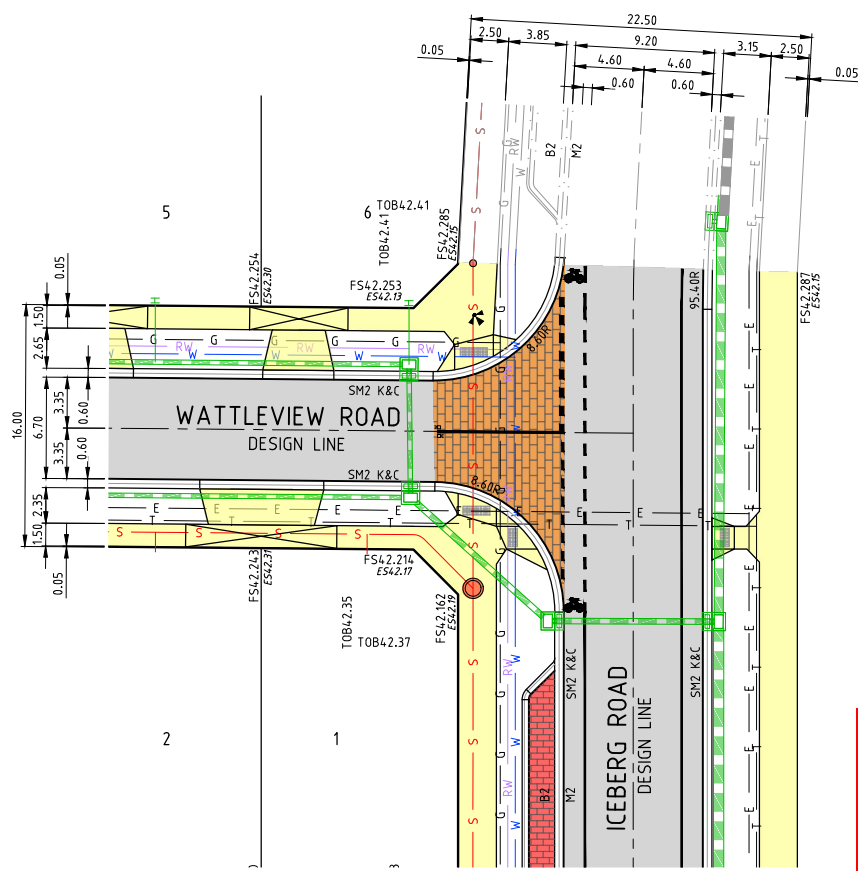

FUNCTIONAL LAYOUT PLAN APPROVAL
CARDINIA SHIRE COUNCIL
 Ref No.: T170521 - Stages 1,2,3
 Sheet: 10 of 17
 Approved by: Justin Conn
CARDINIA SHIRE COUNCIL
 Date: Friday, 5 June 2020

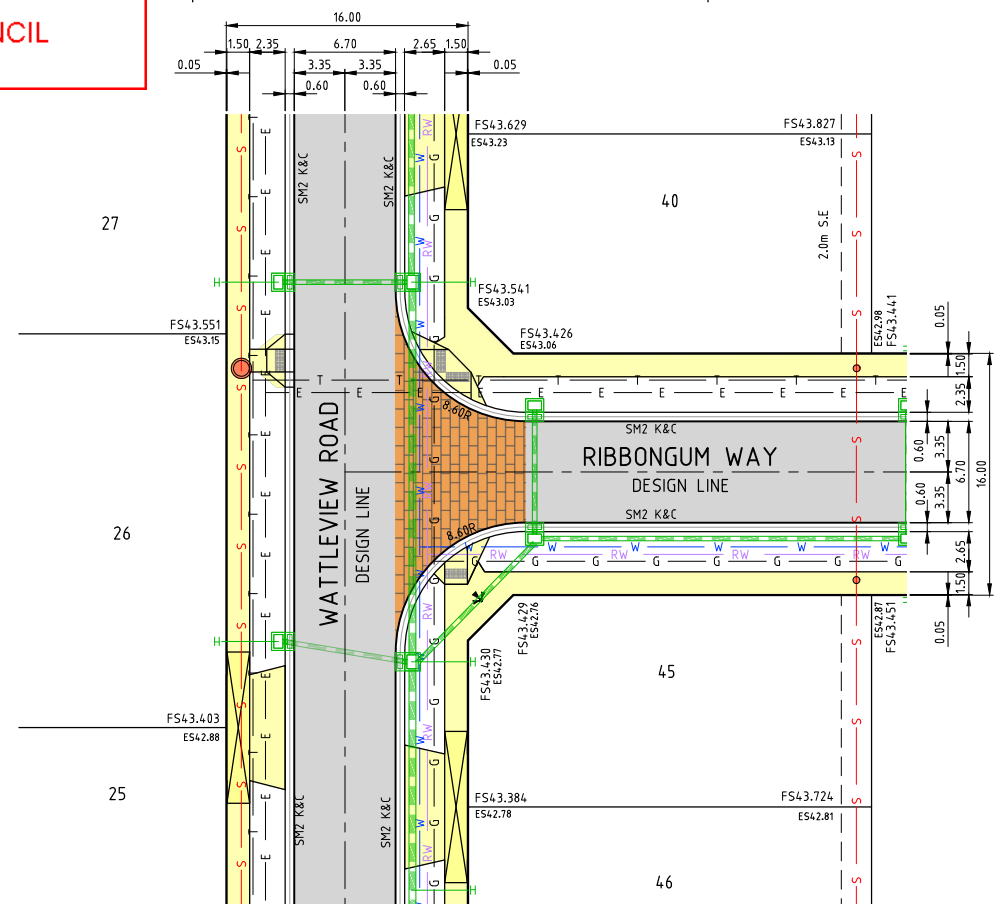
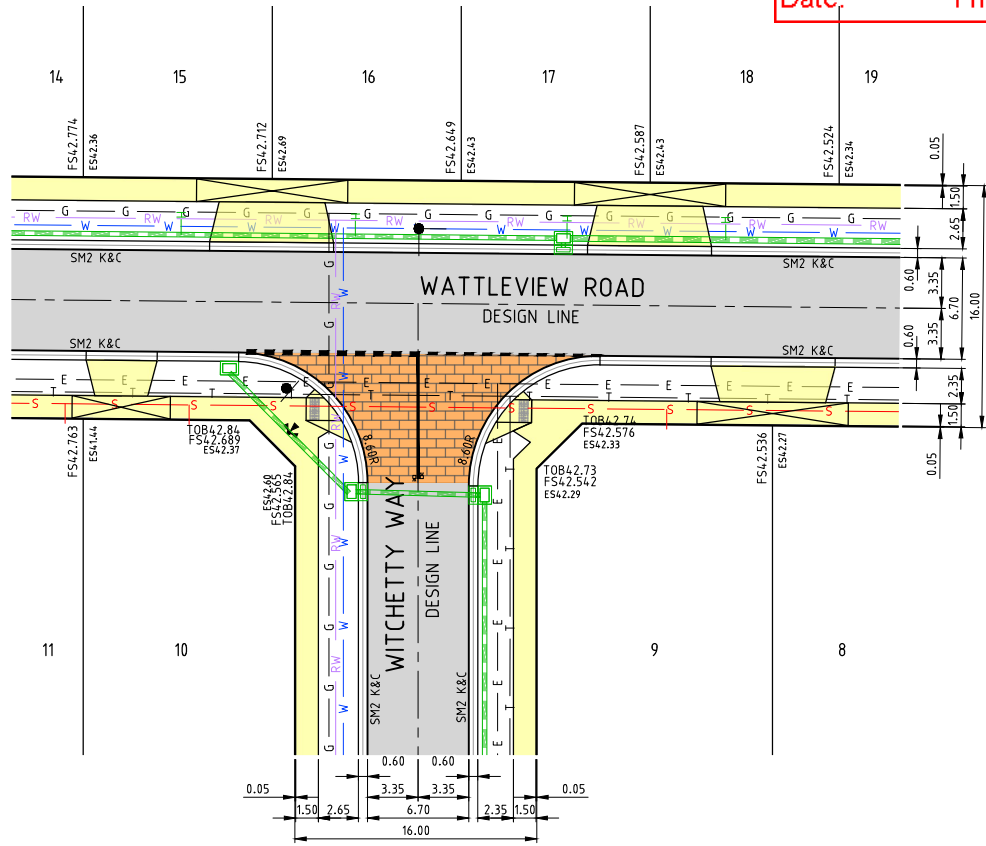

NOTE: TACTILE PAVING
 TACTILE GROUND SURFACE INDICATORS (TGSIS) ARE SHOWN INDICATIVELY AND SHOULD BE CONSTRUCTED IN ACCORDANCE WITH AS/NZS 1428.4.1:2009.

WARNING!
 NO DRAINAGE WORKS SHALL COMMENCE UNTIL THE CONTRACTOR CONFIRMS THE I.L. OF ALL EXISTING DRAINS, AND CONFIRMS IN WRITING WITH THE ENGINEERING SUPERVISOR.

WARNING!
 THE LOCATION OF EXISTING SERVICES SHOWN ON THESE PLANS MUST BE PROVEN ON SITE, THE APPROPRIATE AUTHORITY MUST BE CONTACTED AND THE SERVICES LOCATED PRIOR TO COMMENCEMENT OF ANY WORKS.

Drawing File: C:\126_Sydney\18144-FID01\18144-Beaconsfield Wattle Estate_1073\1_LDESIGN\01_ACAD\03_GENERAL\FUNCTIONAL PLANS\18144\FID01.dwg - 18/11/2020 - 4:57pm - c:\cadd\...

REV	DESCRIPTION	DATE	AMEND	APPD
E	STAGES 4,5,6 SHOWN AS FUTURE WORKS	02/06/20	CB	TL
D	COUNCIL COMMENTS (27/04/20)	12/05/20	CB/PB	TL
C	COUNCIL COMMENTS ADDRESSED	03/04/20	CB	TL
B	COUNCIL COMMENTS ADDRESSED	21/11/19	CB	TL
A	COUNCIL ISSUE	10/09/19	BA	TL

Drawn: B.ADAMS
 Date: 26/04/19
 AN 2591040
 Designed: C.BLISSETT
 Date: 26/04/19
 AN 2771009
 Verified: [blank]
 Date: [blank]
 AN [blank]
 Approved: [blank]
 Date: [blank]
 AN [blank]

- LEGEND**
- EX. WATER MAIN
 - EX. GAS MAIN
 - EX. ELECTRICAL CABLE
 - EX. SEWER MAIN & MH
 - EX. COMM. CABLE & PIT
 - EX. ELEC. O/H LINES
 - EX. DRAIN & PIT
 - WATER
 - RECYCLED WATER
 - ELECTRICITY
 - TELECOMMUNICATIONS
 - TELECOMMUNICATIONS
 - FUTURE WATER
 - FUTURE RECYCLED WATER
 - FUTURE ELECTRICITY
 - FUTURE TELECOMMUNICATIONS
 - FUTURE SEWER MAIN & MANHOLE
 - FUTURE SW DRAIN & PIT
 - FUTURE SW DRAIN & PIT
 - PROPERTY INLETS
 - HOUSE DRAIN

ES20.06 EX. SURFACE LEVEL
 FS21.650 FINISHED SURFACE LEVEL
 ASPHALT PAVEMENT
 CONCRETE PATH / DWAY
 THRESHOLD PAVEMENT
 PARKING BAY TREATMENT

Coords: MGA Levels: AHD

0m 2.5m 5m 10m 15m
 Scale @ A1/A3 1:250 / 1:500

BEAconsfield WATTLE ESTATE
CARDINIA SHIRE COUNCIL
STAGE 1-6
190 KENILWORTH AVENUE, BEAconsfield
INTERSECTION DETAILS
SHEET 01 OF 02
Drawing No. 18144FID01 Rev E
 Sheet No. 09 of 16

DALTON CONSULTING ENGINEERS
 ABN 78 429 221 049
 VICTORIA T 61 3 9813 7400 W dceng.com.au
 QUEENSLAND T 61 7 3374 9000 E info@dceng.com.au

FUNCTIONAL

Drawing File: C:\126_Sydney\data\SYNERGY-HE\18144-Beaconsfield Wattle Estate_1073\1_DESIGN\01_ACAD\03_GENERAL\FUNCTIONAL PLANS\18144FID02.dwg - 18/11/2020 - 4:57pm - -consult-
 Date/Time: Tue Jun 02, 2020 - 4:57pm - -consult-

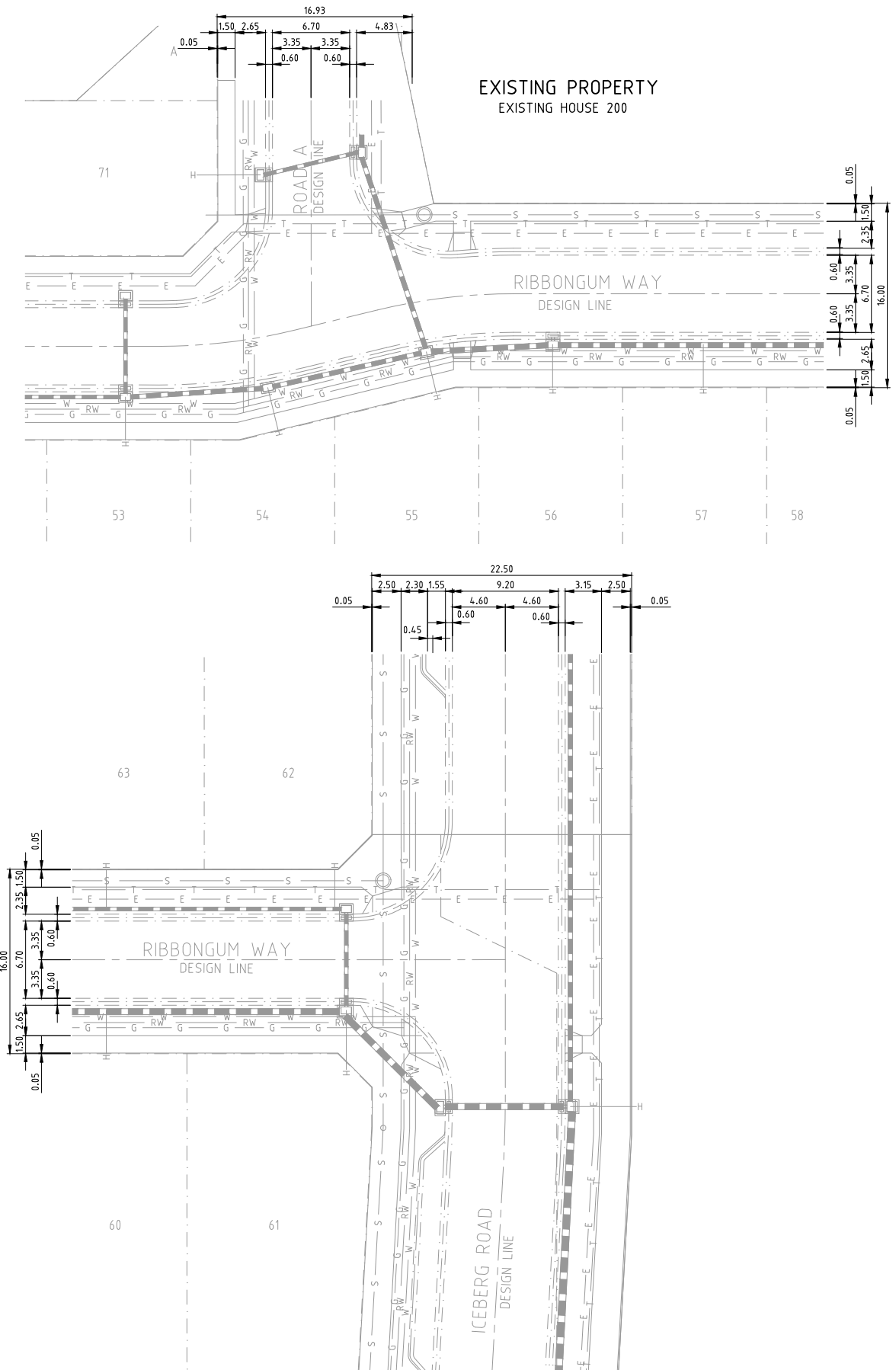

FUNCTIONAL LAYOUT PLAN APPROVAL
CARDINIA SHIRE COUNCIL
 Ref No.: T170521 - Stages 1,2,3
 Sheet: 11 of 17
 Approved by: Justin Conn
CARDINIA SHIRE COUNCIL
 Date: Friday, 5 June 2020

NOTE: TACTILE PAVING
 TACTILE GROUND SURFACE INDICATORS (TGSIS) ARE SHOWN INDICATIVELY AND SHOULD BE CONSTRUCTED IN ACCORDANCE WITH AS/NZS 1428.4.1:2009.

WARNING!
 NO DRAINAGE WORKS SHALL COMMENCE UNTIL THE CONTRACTOR CONFIRMS THE I.L. OF ALL EXISTING DRAINS, AND CONFIRMS IN WRITING WITH THE ENGINEERING SUPERVISOR.

WARNING!
 THE LOCATION OF EXISTING SERVICES SHOWN ON THESE PLANS MUST BE PROVEN ON SITE, THE APPROPRIATE AUTHORITY MUST BE CONTACTED AND THE SERVICES LOCATED PRIOR TO COMMENCEMENT OF ANY WORKS.

REV	DESCRIPTION	DATE	AMEND	APPD
E	STAGES 4,5,6 SHOWN AS FUTURE WORKS	02/06/20	CB	TL
D	COUNCIL COMMENTS (27/04/20)	12/05/20	CB/PB	TL
C	COUNCIL COMMENTS ADDRESSED	03/04/20	CB	TL
B	COUNCIL COMMENTS ADDRESSED	21/11/19	CB	TL
A	COUNCIL ISSUE	10/09/19	BA	TL

Drawn Date AN B.ADAMS 26/04/19 2591040
 Designed Date AN C.BLISSETT 26/04/19 2771009
 Verified Date AN
 Approved Date AN
 © Dalton Consulting Engineers Pty Ltd

LEGEND

EX. WATER MAIN	WATER	FUTURE TELECOMMUNICATIONS	ES20.06	EX. SURFACE LEVEL
EX. GAS MAIN	RECYCLED WATER	SEWER MAIN & MANHOLE	FS21.650	FINISHED SURFACE LEVEL
EX. ELECTRICAL CABLE	ELECTRICITY	FUTURE SEWER MAN & MANHOLE	ASPHALT PAVEMENT	CONCRETE PATH / DWYAY
EX. SEWER MAIN & MH	TELECOMMUNICATIONS	SW DRAIN & PIT	THRESHOLD PAVEMENT	PARKING BAY TREATMENT
EX. COMM. CABLE & PIT	FUTURE GAS	MW DRAIN & PIT	PROPERTY INLETS	
EX. ELEC. O/H LINES	FUTURE WATER	FUTURE SW DRAIN & PIT	HOUSE DRAIN	
EX. DRAIN & PIT	FUTURE RECYCLED WATER			
GAS	FUTURE ELECTRICITY			

Coords: MGA Levels: AHD

 Scale @ A1/A3 1:250 / 1:500

BEAconsfield WATTLE ESTATE
CARDINIA SHIRE COUNCIL
STAGE 1-6
190 KENILWORTH AVENUE, BEAconsfield
INTERSECTION DETAILS
SHEET 02 OF 02
Drawing No. 18144FID02 Rev E
 Sheet No. 10 of 16

DALTON CONSULTING ENGINEERS
 ABN 78 429 221 049
 VICTORIA T 61 3 9813 7400 W dceng.com.au
 QUEENSLAND T 61 7 3374 9000 E info@dceng.com.au
FUNCTIONAL

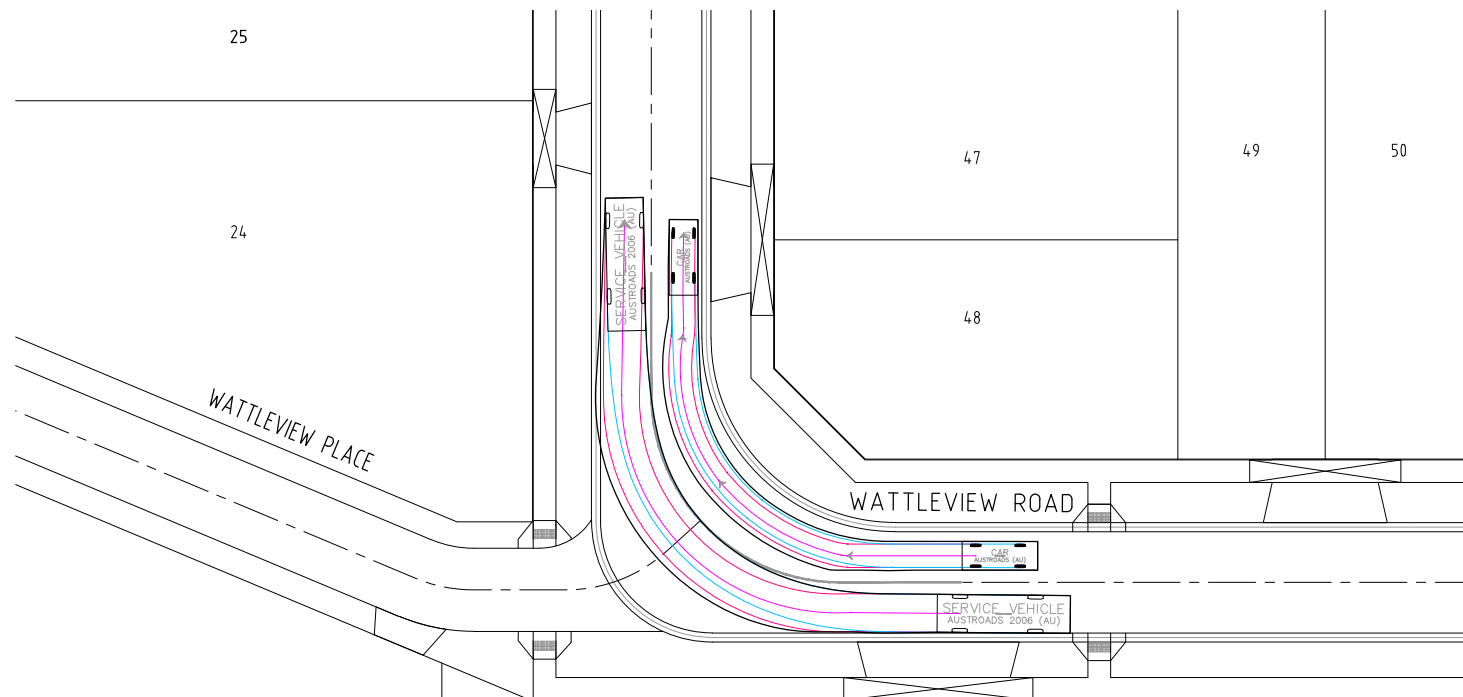
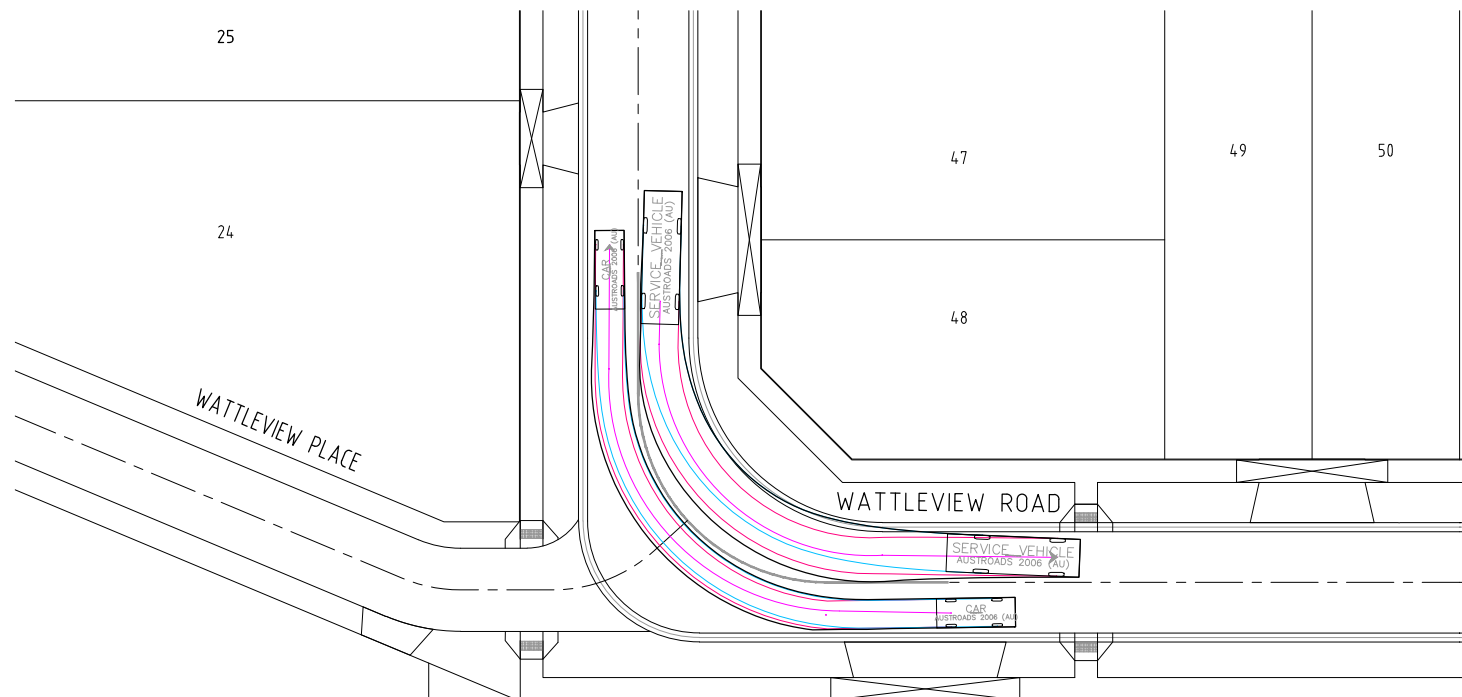

8.8m DESIGN VEHICLE - LEFT TURN
WATTLEVIEW ROAD

8.8m DESIGN VEHICLE - RIGHT TURN
WATTLEVIEW ROAD

FUNCTIONAL LAYOUT PLAN APPROVAL
CARDINIA SHIRE COUNCIL
 Ref No.: T170521 - Stages 1,2,3
 Sheet: 12 of 17
 Approved by: Justin Conn
 CARDINIA SHIRE COUNCIL
 Date: Friday, 5 June 2020

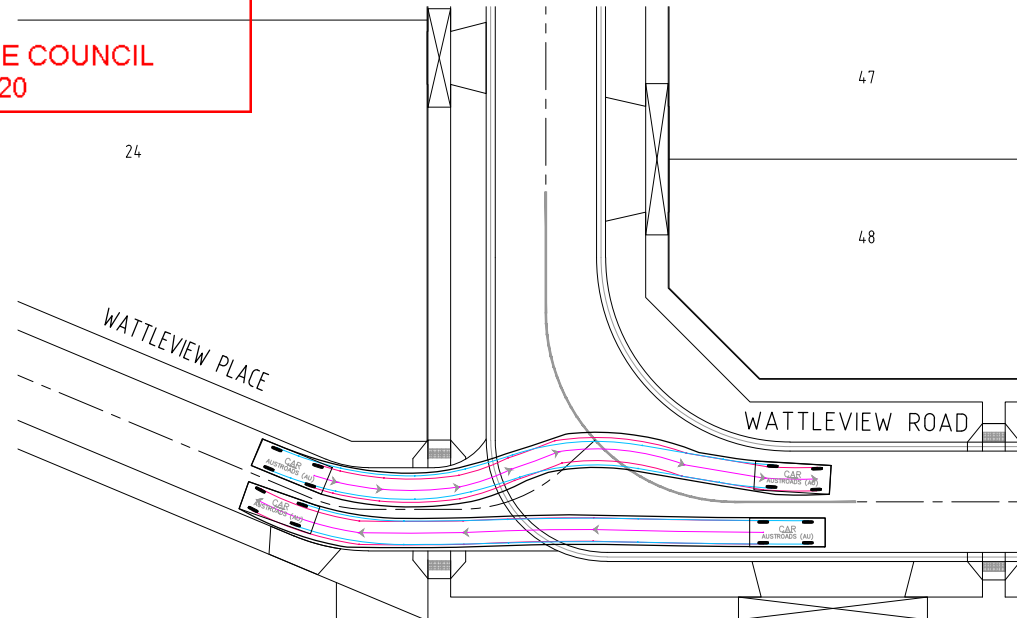
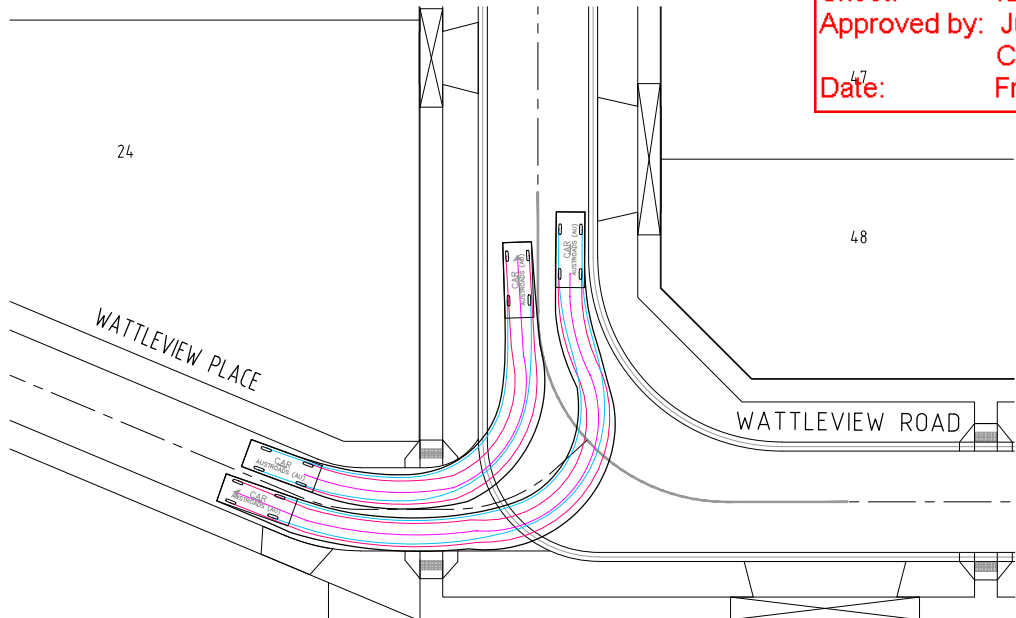

5.0m DESIGN VEHICLE - INGRESS AND EGRESS NORTH
WATTLEVIEW PLACE

5.0m DESIGN VEHICLE - INGRESS AND EGRESS EAST
WATTLEVIEW PLACE

Drawing File: C:\126_Sydney\data\SYNERGY-HE\18144-Beaconsfield Wattle Estate_1073\1_DESIGN\01_ACAD\03_GENERAL\FUNCTIONAL PLANS\18144FTT01.dwg - 18/14/2020 - 4:57pm - c:\csd\...
 Date/Time: Tue Jun 02, 2020 - 4:57pm - c:\csd\...

REV	DESCRIPTION	DATE	AMEND	APPD
E	STAGES 4,5,6 SHOWN AS FUTURE WORKS	02/06/20	CB	TL
D	COUNCIL COMMENTS (27/04/20)	12/05/20	CB/PB	TL
C	COUNCIL COMMENTS ADDRESSED	03/04/20	CB	TL
B	COUNCIL COMMENTS ADDRESSED	21/11/19	CB	TL
A	COUNCIL ISSUE	10/09/19	BA	TL

Drawn: B.ADAMS
 Date: 26/04/19
 AN: 2591040
 Designed: C.BLISSETT
 Date: 26/04/19
 AN: 2771009
 Verified: AN
 Date: AN
 Approved: AN
 Date: AN

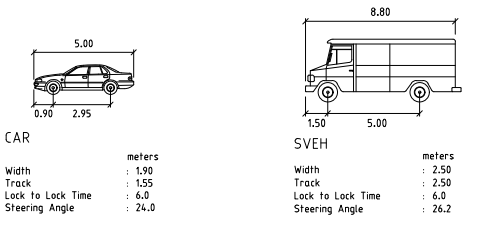

Scale @ A1/A3 1:250 / 1:500

BEAONSFIELD WATTLE ESTATE
CARDINIA SHIRE COUNCIL
STAGE 1-6
190 KENILWORTH AVENUE, BEAONSFIELD
TURNING PATH PLAN
SHEET 01 OF 06
Drawing No. 18144FTT01 Rev E
 Sheet No. 11 of 16

DALTON CONSULTING ENGINEERS
 ABN 78 429 221 049
 VICTORIA T 61 3 9813 7400 W dceng.com.au
 QUEENSLAND T 61 7 3374 9000 E info@dceng.com.au

FUNCTIONAL

FUNCTIONAL LAYOUT PLAN APPROVAL
CARDINIA SHIRE COUNCIL
 Ref No.: T170521 - Stages 1,2,3
 Sheet: 13 of 17
 Approved by: Justin Conn
CARDINIA SHIRE COUNCIL
 Date: Friday, 5 June 2020

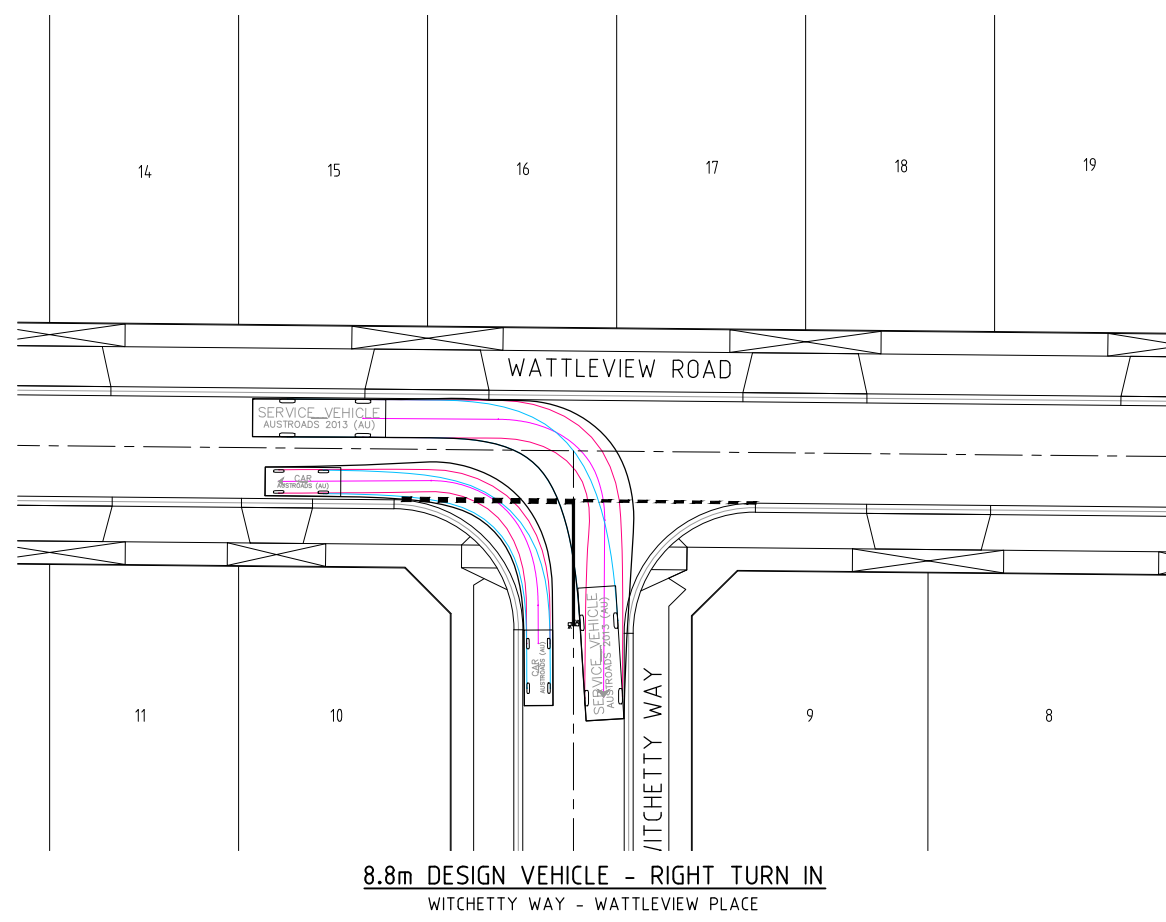
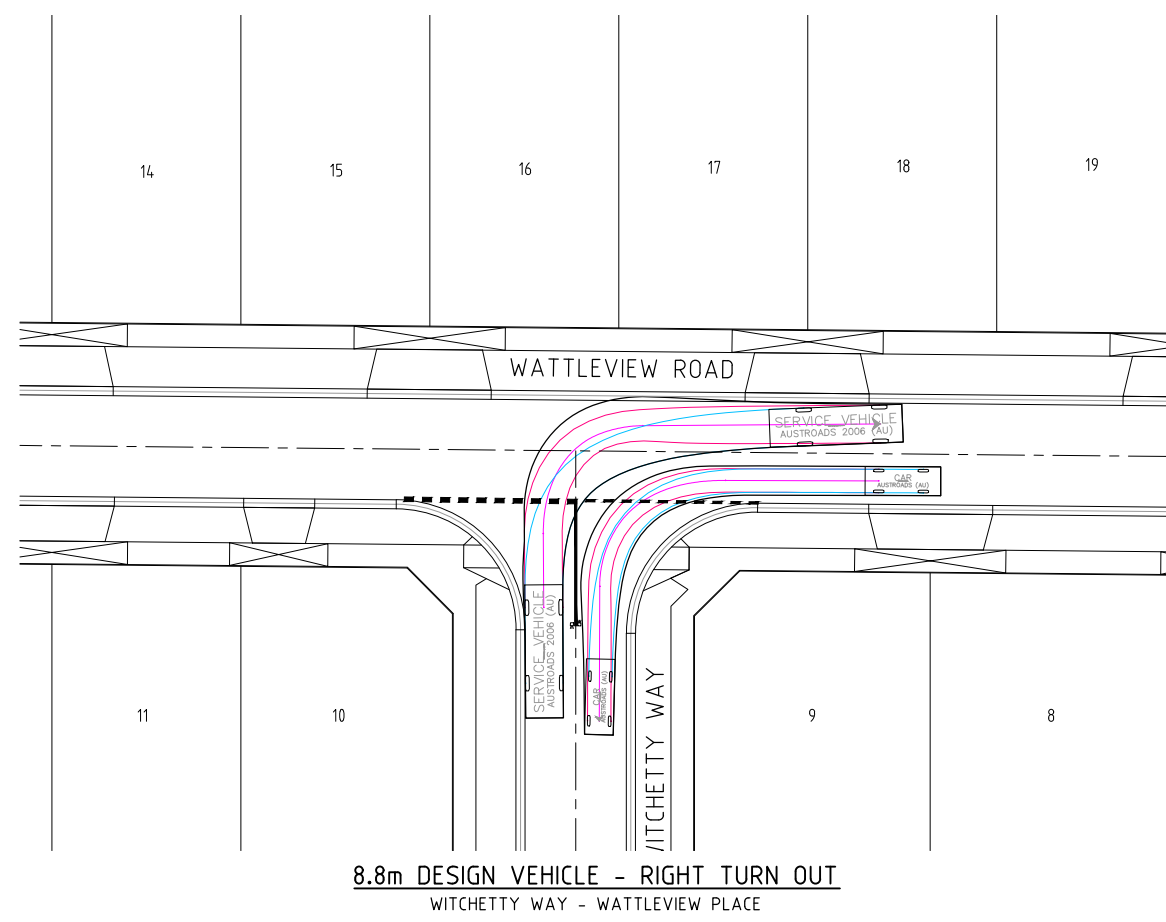
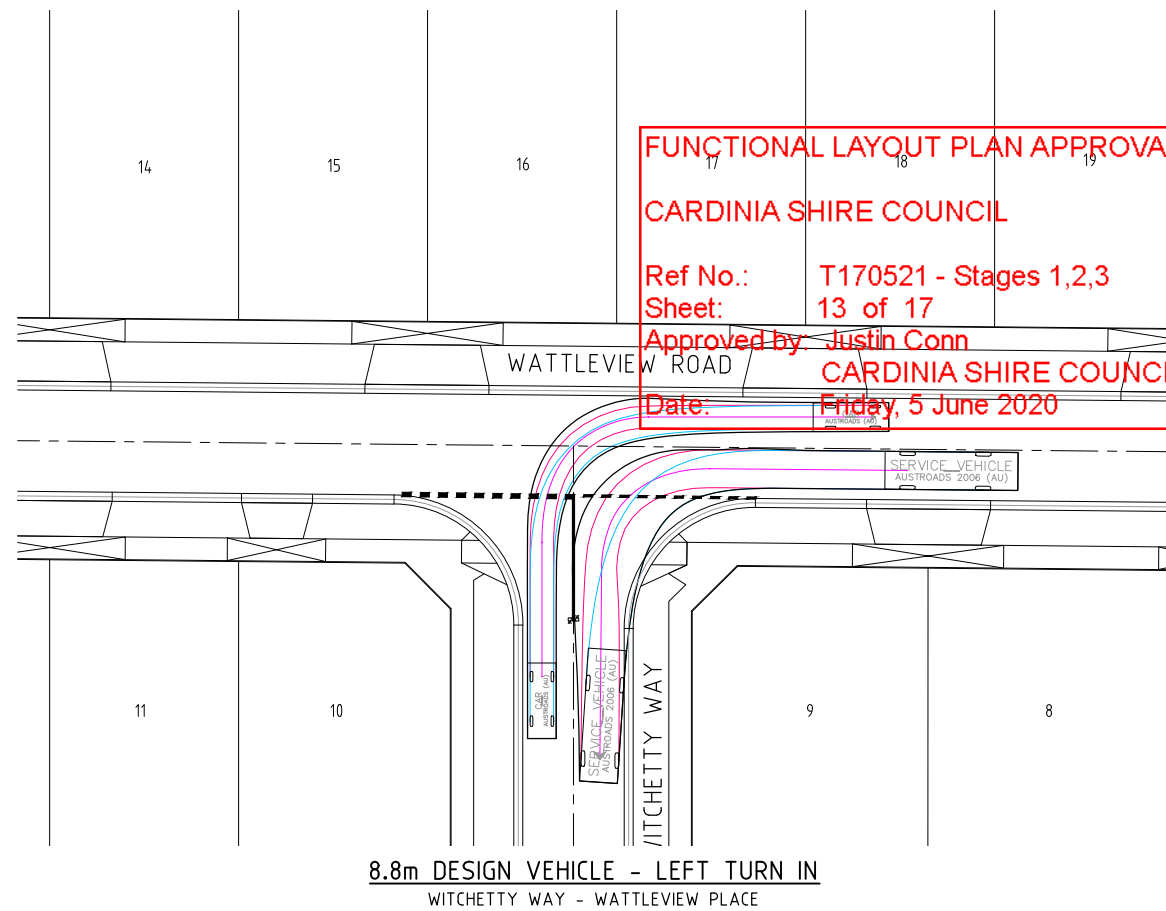
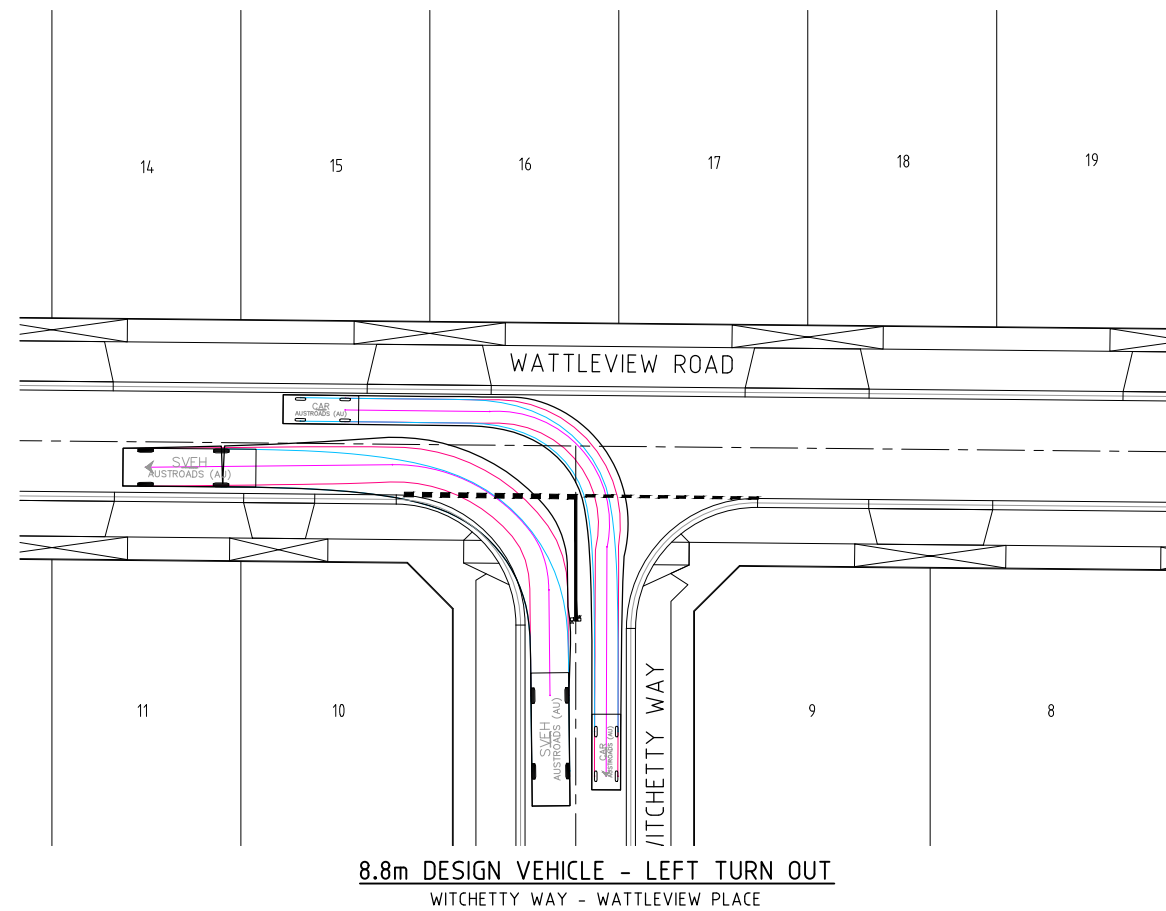

Drawing File: C:\126_Sydney\Info\ENERGY-ME\18144-Beaconsfield Wattle Estate_1073\1 DESIGN\01_ACAD\03_GENERAL\FUNCTIONAL PLANS\18144FTT01.dwg - 18/14/2020 - 4:57pm - ccsksh--
 Date/Time: Tue Jun 02, 2020 - 4:57pm - ccsksh--

REV	DESCRIPTION	DATE	AMEND	APP'D
E	STAGES 4,5,6 SHOWN AS FUTURE WORKS	02/06/20	CB	TL
D	COUNCIL COMMENTS ADDRESSED (27/04/20)	12/05/20	CB/PB	TL
C	COUNCIL COMMENTS ADDRESSED	03/04/20	CB	TL
B	COUNCIL COMMENTS ADDRESSED	21/11/19	CB	TL
A	COUNCIL ISSUE	10/09/19	BA	TL

Drawn: B.ADAMS
 Date: 26/04/19
 AN: 2591040
 Designed: C.BLISSETT
 Date: 26/04/19
 AN: 2771009
 Verified: AN
 Date: AN
 Approved: AN
 Date: AN

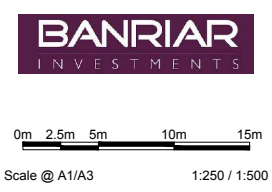
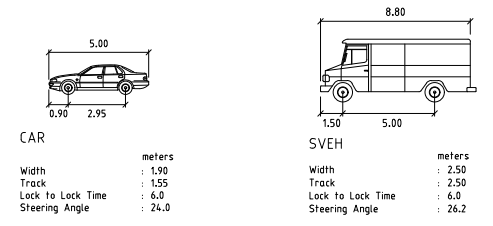

BEAONSFIELD WATTLE ESTATE
CARDINIA SHIRE COUNCIL
STAGE 1-6
190 KENILWORTH AVENUE, BEAONSFIELD
TURNING PATH PLAN
SHEET 02 OF 06
Drawing No. 18144FTT02 Rev E
 Sheet No. 12 of 16

DALTON CONSULTING ENGINEERS
 ABN 78 429 221 049
 QUEENSLAND
 T 61 7 3374 9000
 E info@dceng.com.au

VICTORIA
 T 61 3 9813 7400
 W dceng.com.au

FUNCTIONAL

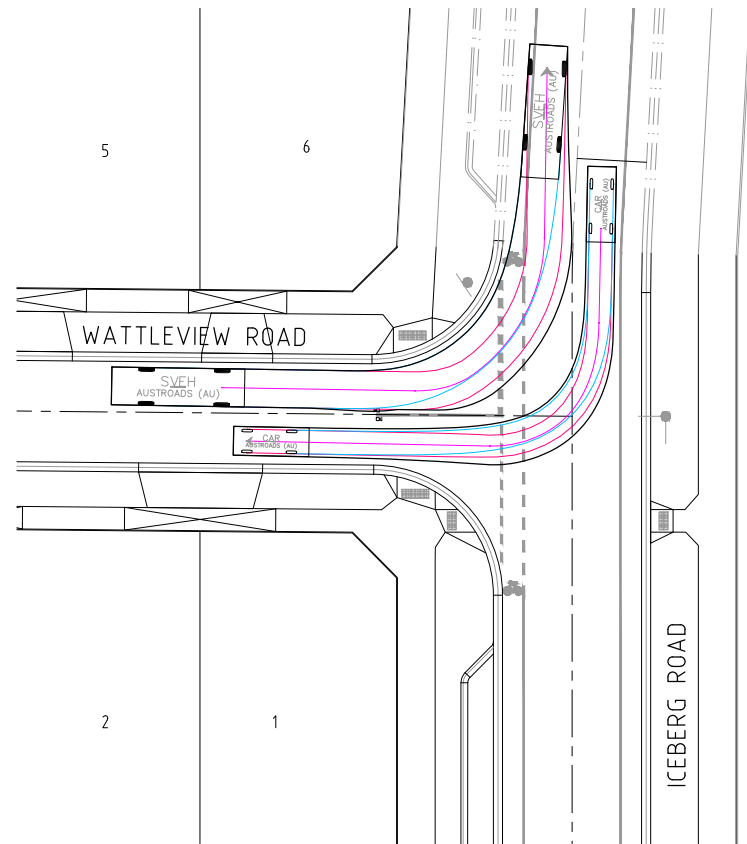

8.8m DESIGN VEHICLE - LEFT TURN OUT
ICEBERG ROAD - WATTLEVIEW PLACE

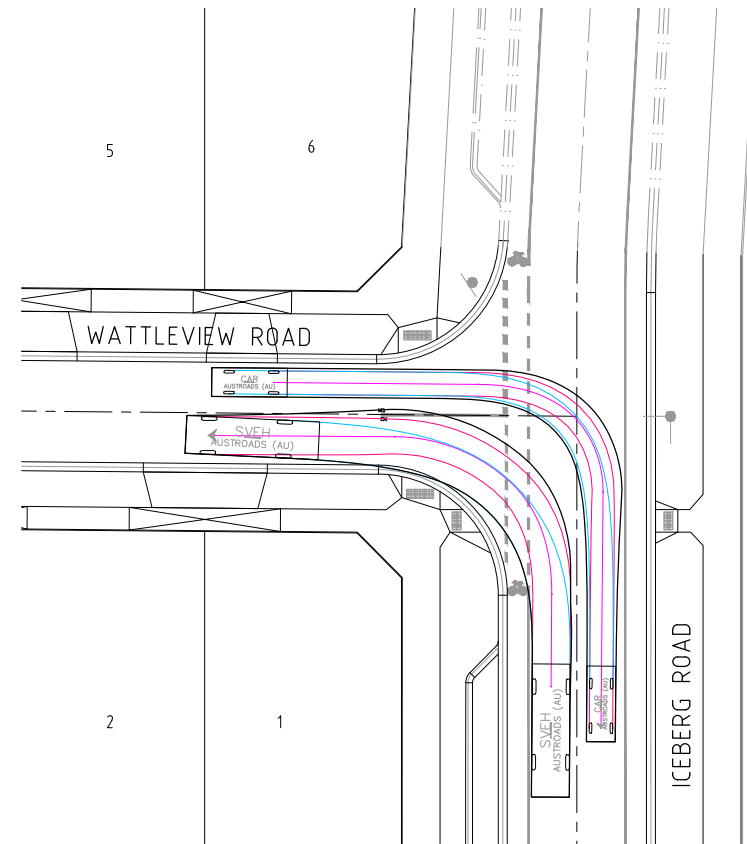

8.8m DESIGN VEHICLE - LEFT TURN IN
ICEBERG ROAD - WATTLEVIEW PLACE

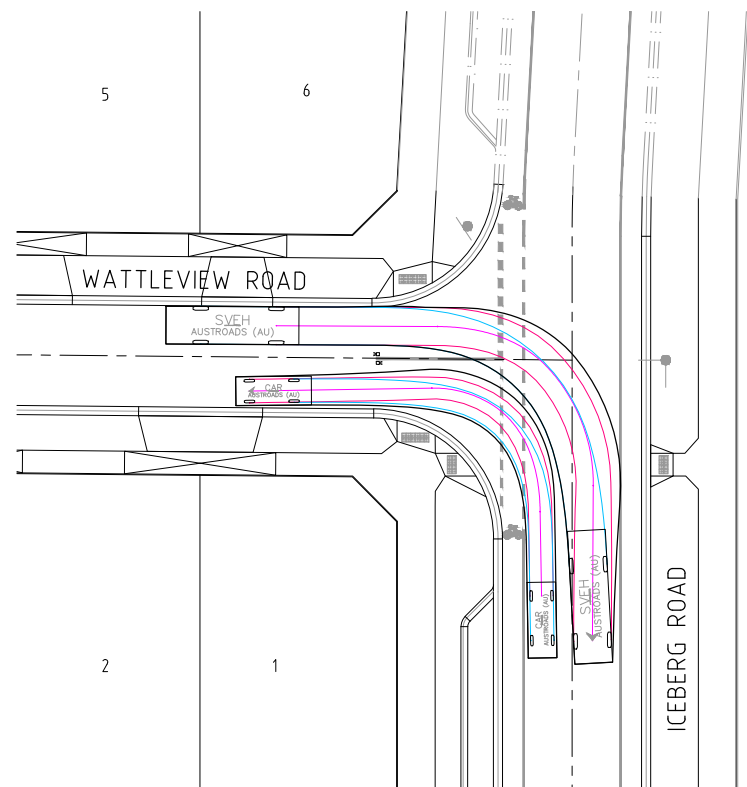

8.8m DESIGN VEHICLE - RIGHT TURN OUT
ICEBERG ROAD - WATTLEVIEW PLACE

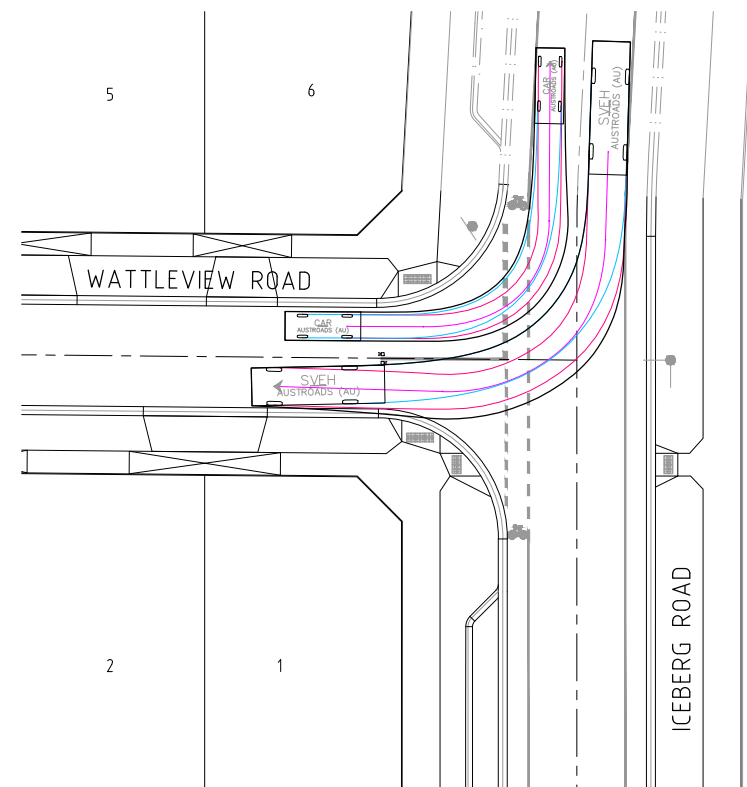

8.8m DESIGN VEHICLE - RIGHT TURN IN
ICEBERG ROAD - WATTLEVIEW PLACE

FUNCTIONAL LAYOUT PLAN APPROVAL

CARDINIA SHIRE COUNCIL

Ref No.: T170521 - Stages 1,2,3
 Sheet: 14 of 17
 Approved by: Justin Conn
 CARDINIA SHIRE COUNCIL
 Date: Friday, 5 June 2020

NOT TO BE USED FOR CONSTRUCTION

REV	DESCRIPTION	DATE	AMEND	APPD
E	STAGES 4,5,6 SHOWN AS FUTURE WORKS	02/06/20	CB	TL
D	COUNCIL COMMENTS (27/04/20)	12/05/20	CB/PB	TL
C	COUNCIL COMMENTS ADDRESSED	03/04/20	CB	TL
B	COUNCIL COMMENTS ADDRESSED	21/11/19	CB	TL
A	COUNCIL ISSUE	10/09/19	BA	TL

Drawn: B.ADAMS
 Date: 26/04/19
 AN: 2591040
 Designed: C.BLISSETT
 Date: 26/04/19
 AN: 2771009
 Verified: AN
 Date: AN
 Approved: AN
 Date: AN

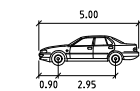

CAR
 Width : 1.90 meters
 Track : 1.55
 Lock to Lock Time : 6.0
 Steering Angle : 24.0

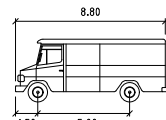

8.8m
 SVEH
 Width : 2.50 meters
 Track : 2.50
 Lock to Lock Time : 6.9
 Steering Angle : 26.2

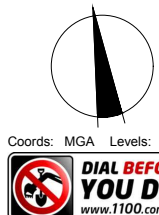

Scale @ A1/A3 1:250 / 1:500

BEACONSFIELD WATTLE ESTATE
CARDINIA SHIRE COUNCIL
STAGE 1-6
190 KENILWORTH AVENUE, BEACONSFIELD
TURNING PATH PLAN
SHEET 03 OF 06
Drawing No. 18144FTT03 **Rev E**
 Sheet No. 13 of 16

DALTON CONSULTING ENGINEERS
 ABN 78 429 221 049
 VICTORIA
 T 61 3 9813 7400
 W dceng.com.au
 QUEENSLAND
 T 61 7 3374 9000
 E info@dceng.com.au

FUNCTIONAL

Drawing File: C:\126_Sydney\data\SYNERGY-NE\18144-Beaconsfield Wattle Estate_1073\1_DESIGN\01_ACAD\03_GENERAL\FUNCTIONAL PLANS\18144FTT03.dwg - 18/14/2020 - 4:57pm - ccsk@dceng.com.au
 Date/Time: Tue Jun 02, 2020 - 4:57pm - ccsk@dceng.com.au
 Written dimensions to take precedence over scale. Contractor shall check and verify all dimensions on site. Discrepancies to be brought to the attention of the Superintendent. © Dalton Consulting Engineers Pty Ltd

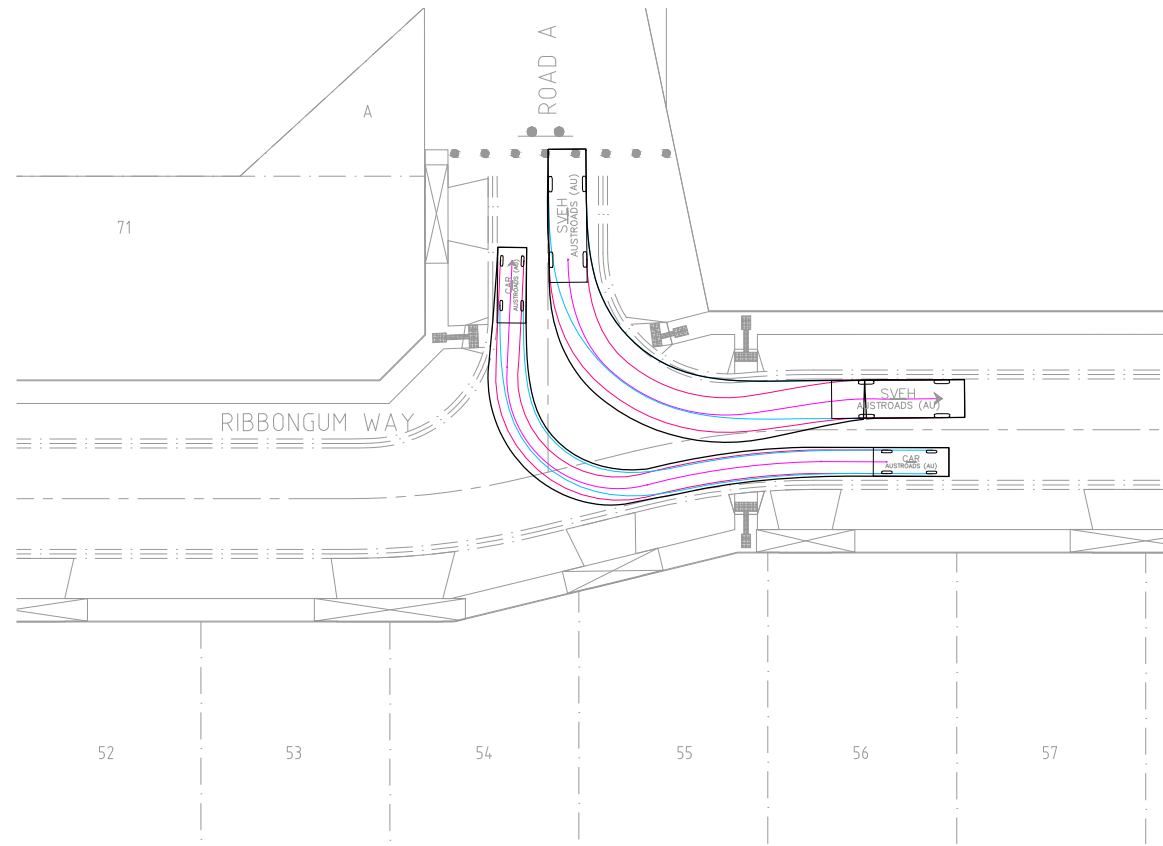

8.8m DESIGN VEHICLE - LEFT TURN OUT
FUTURE RIBBONGUM WAY - ROAD A

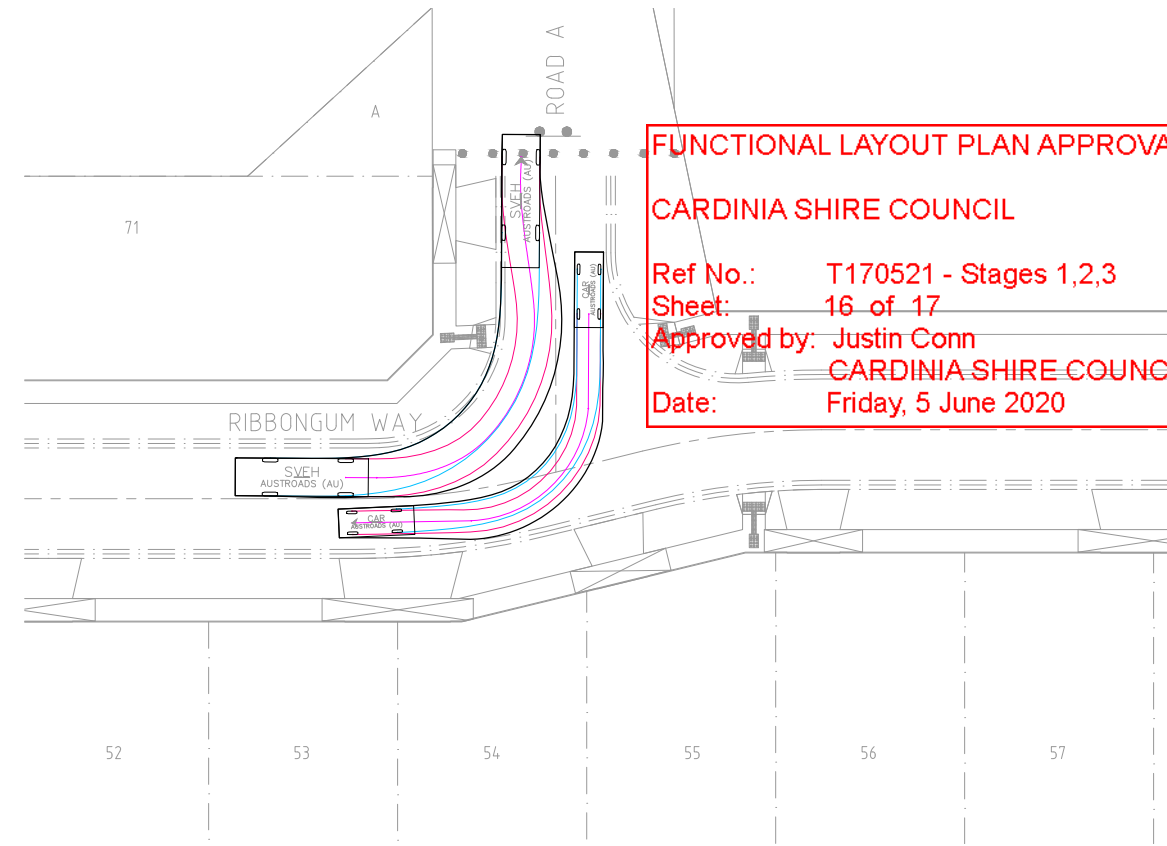

8.8m DESIGN VEHICLE - LEFT TURN IN
FUTURE RIBBONGUM WAY - ROAD A

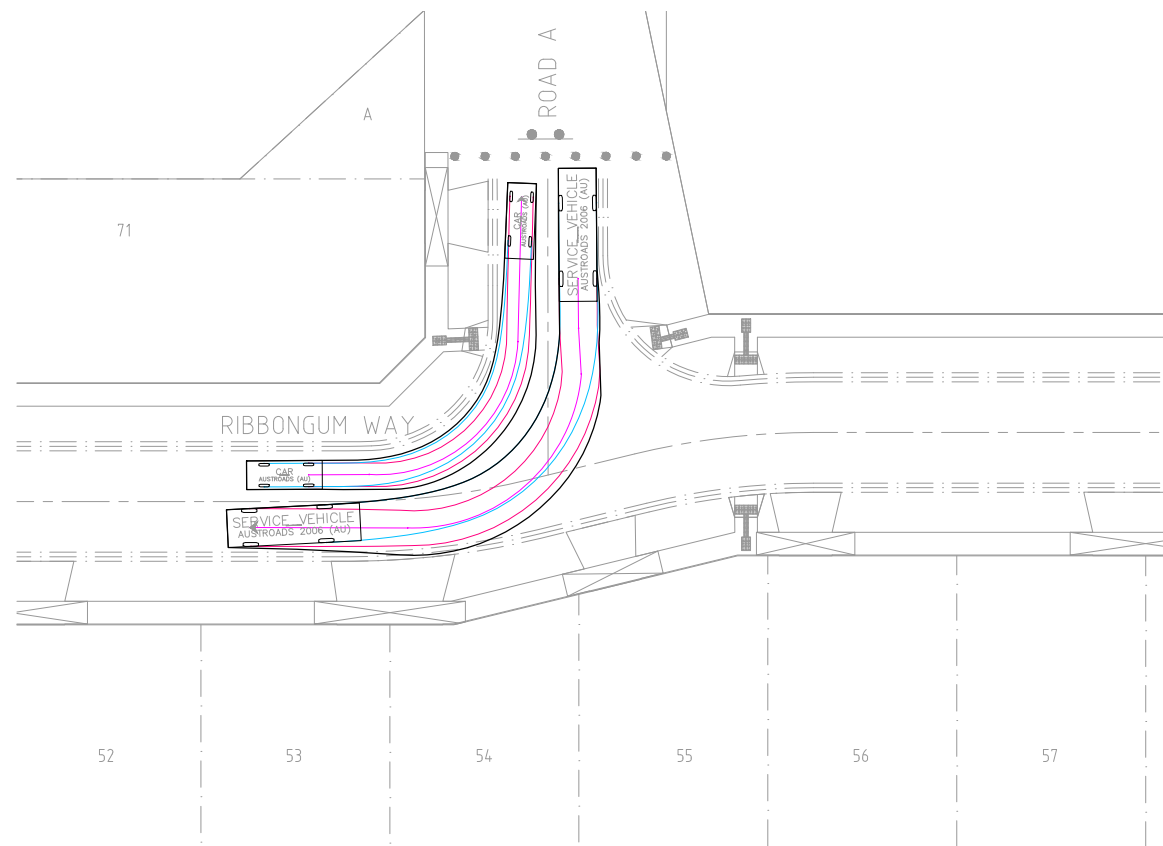

8.8m DESIGN VEHICLE - RIGHT TURN OUT
FUTURE RIBBONGUM WAY - ROAD A

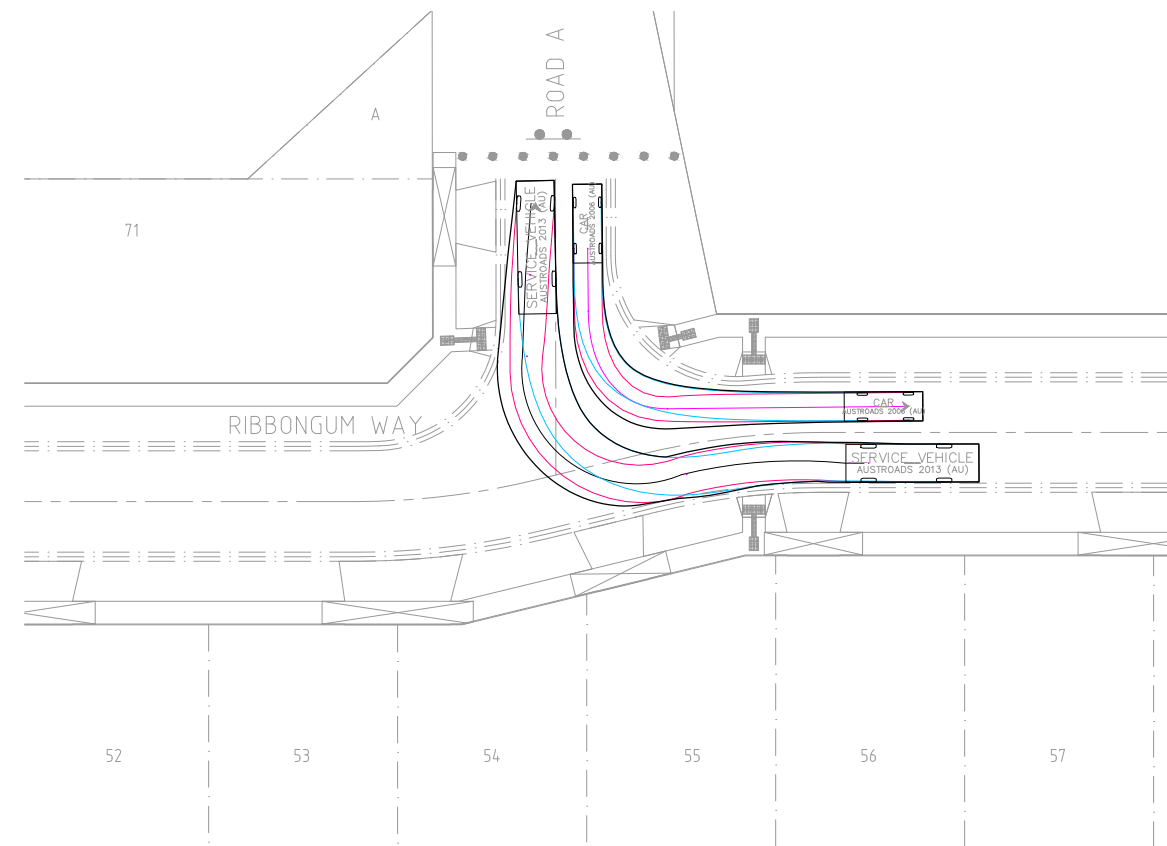

8.8m DESIGN VEHICLE - RIGHT TURN IN
FUTURE RIBBONGUM WAY - ROAD A

FUNCTIONAL LAYOUT PLAN APPROVAL
CARDINIA SHIRE COUNCIL
Ref No.: T170521 - Stages 1,2,3
Sheet: 16 of 17
Approved by: Justin Conn
CARDINIA SHIRE COUNCIL
Date: Friday, 5 June 2020

Drawing File: C:\126_Sydney\data\SYNERGY-HE\18144-Beaconsfield Wattle Estate_18144_FT05.dwg - 18144FTT05.dwg
Date/Time: Tue Jun 02, 2020 - 4:57pm - ccs@dceng.com

NOT TO BE USED FOR CONSTRUCTION				
REV	DESCRIPTION	DATE	AMEND	APPD
E	STAGES 4,5,6 SHOWN AS FUTURE WORKS	02/06/20	CB	TL
D	COUNCIL COMMENTS (27/04/20)	12/05/20	CB/PB	TL
C	COUNCIL COMMENTS ADDRESSED	03/04/20	CB	TL
B	COUNCIL COMMENTS ADDRESSED	21/11/19	CB	TL
A	COUNCIL ISSUE	10/09/19	BA	TL

Drawn: B.ADAMS
Date: 26/04/19
AN: 2591040
Designed: C.BLISSETT
Date: 26/04/19
AN: 2771009
Verified: AN
Date: AN
Approved: AN
Date: AN

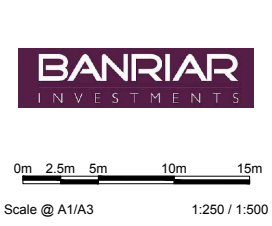
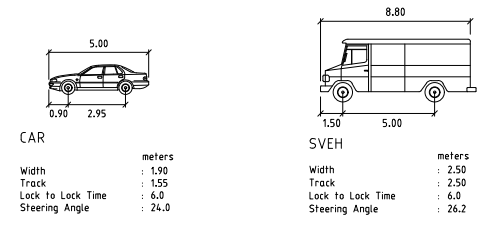

BEAONSFIELD WATTLE ESTATE
CARDINIA SHIRE COUNCIL
STAGE 1-6
190 KENILWORTH AVENUE, BEAONSFIELD
TURNING PATH PLAN
SHEET 05 OF 06
Drawing No. 18144FTT05 **Rev E**
Sheet No. 15 of 16

FUNCTIONAL

Drawing File: C:\126_Sydney\data\SYNERGY-HE\18144-Beaconsfield Wattle Estate_1073\1_DESIGN\01_ACAD\03_GENERAL\FUNCTIONAL PLANS\18144FTT06.dwg - 18/14/2020 - 4:57pm - ccs@dceng.com.au
 Date/Time: Tue Jun 02, 2020 - 4:57pm - ccs@dceng.com.au

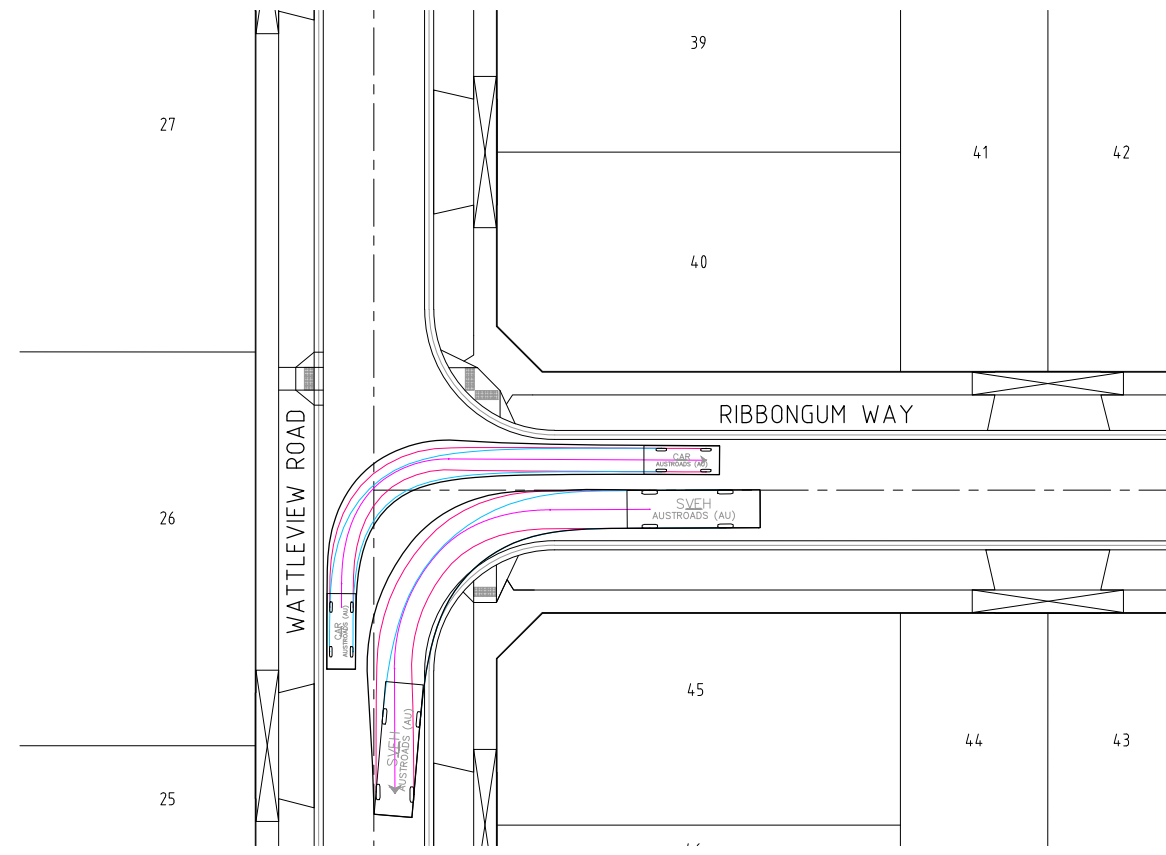

8.8m DESIGN VEHICLE - LEFT TURN OUT
WATTLEVIEW ROAD - RIBBONGUM WAY

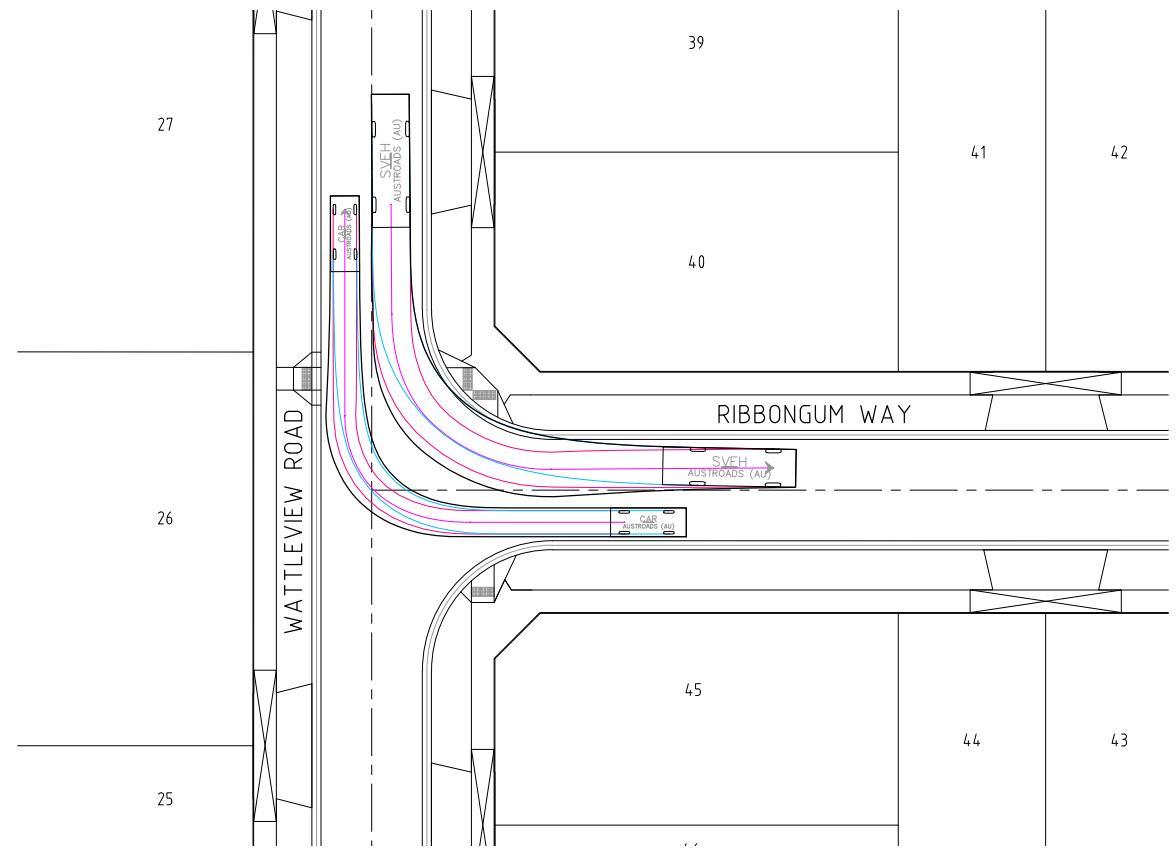

8.8m DESIGN VEHICLE - LEFT TURN IN
WATTLEVIEW ROAD - RIBBONGUM WAY

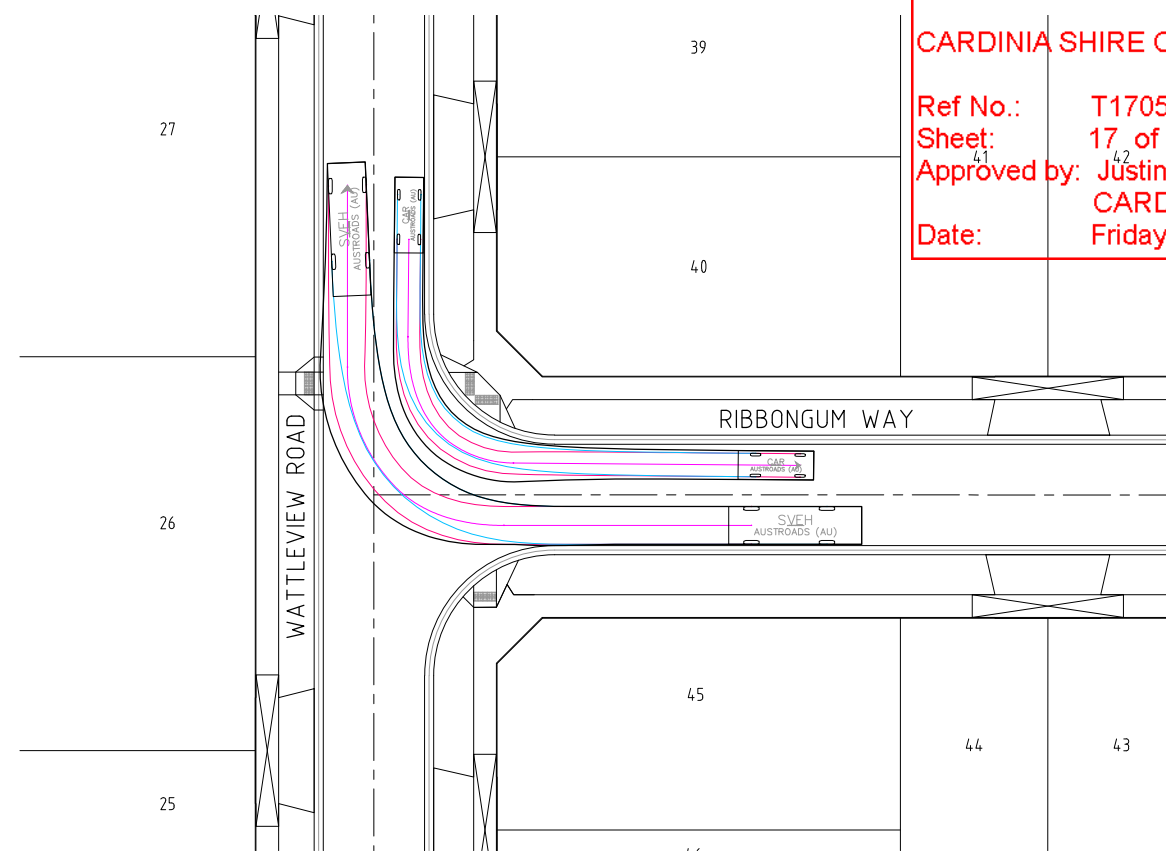

8.8m DESIGN VEHICLE - RIGHT TURN OUT
WATTLEVIEW ROAD - RIBBONGUM WAY

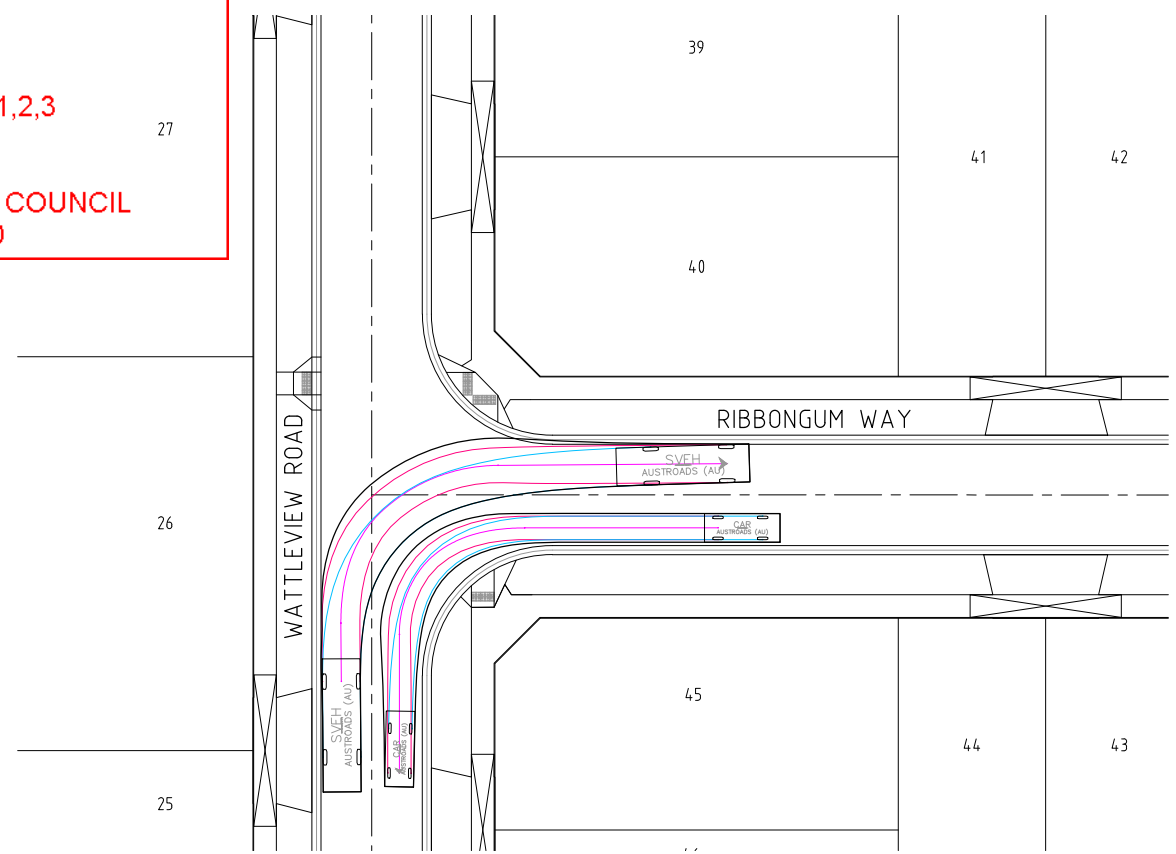

8.8m DESIGN VEHICLE - RIGHT TURN IN
WATTLEVIEW ROAD - RIBBONGUM WAY

FUNCTIONAL LAYOUT PLAN APPROVAL

CARDINIA SHIRE COUNCIL

 Ref No.: T170521 - Stages 1,2,3
 Sheet: 17 of 17
 Approved by: Justin Conn
CARDINIA SHIRE COUNCIL
 Date: Friday, 5 June 2020

NOT TO BE USED FOR CONSTRUCTION

REV	DESCRIPTION	DATE	AMEND	APPD
E	STAGES 4,5,6 SHOWN AS FUTURE WORKS	02/06/20	CB	TL
D	COUNCIL COMMENTS (27/04/20)	12/05/20	CB/PB	TL
C	COUNCIL COMMENTS ADDRESSED	03/04/20	CB	TL
B	COUNCIL COMMENTS ADDRESSED	21/11/19	CB	TL
A	COUNCIL ISSUE	10/09/19	BA	TL

Drawn: B.ADAMS
 Date: 26/04/19
 AN: 2591040
 Designed: C.BLISSETT
 Date: 26/04/19
 AN: 2771009
 Verified: AN
 Date: AN
 Approved: AN
 Date: AN

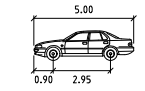

CAR

Width : 1.90 meters
 Track : 1.55
 Lock to Lock Time : 6.0
 Steering Angle : 24.0

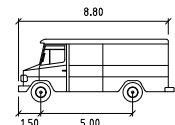

SVEH

Width : 2.50 meters
 Track : 2.50
 Lock to Lock Time : 6.9
 Steering Angle : 26.2

Coords: MGA Levels: AHD

www.1100.com.au



Scale @ A1/A3 1:250 / 1:500

BEAONSFIELD WATTLE ESTATE
CARDINIA SHIRE COUNCIL
STAGE 1-6
190 KENILWORTH AVENUE, BEAONSFIELD
TURNING PATH PLAN
SHEET 06 OF 06
Drawing No. 18144FTT06 **Rev E**
 Sheet No. 16 of 16

DALTON CONSULTING ENGINEERS
 ABN 78 429 221 049
 VICTORIA T 61 3 9813 7400 W dceng.com.au
 QUEENSLAND T 61 7 3374 9000 E info@dceng.com.au

FUNCTIONAL