

PLAN FOR ENDORSEMENT (PS 730185N) BEING
 STAGES 5 & 6 OF BEACONSFIELD ROSES ESTATE
 AT No. 226 RIX ROAD, BEACONSFIELD
 PART CROWN ALLOTMENT 31
 PARISH OF PAKENHAM

SURVEY REF : 18028
 DATE : 10/12/2015

SCALE 1500 METRIC
 ORIGINAL SHEET SIZE (A-1)

M.G.A. - 94
 ZONE 55

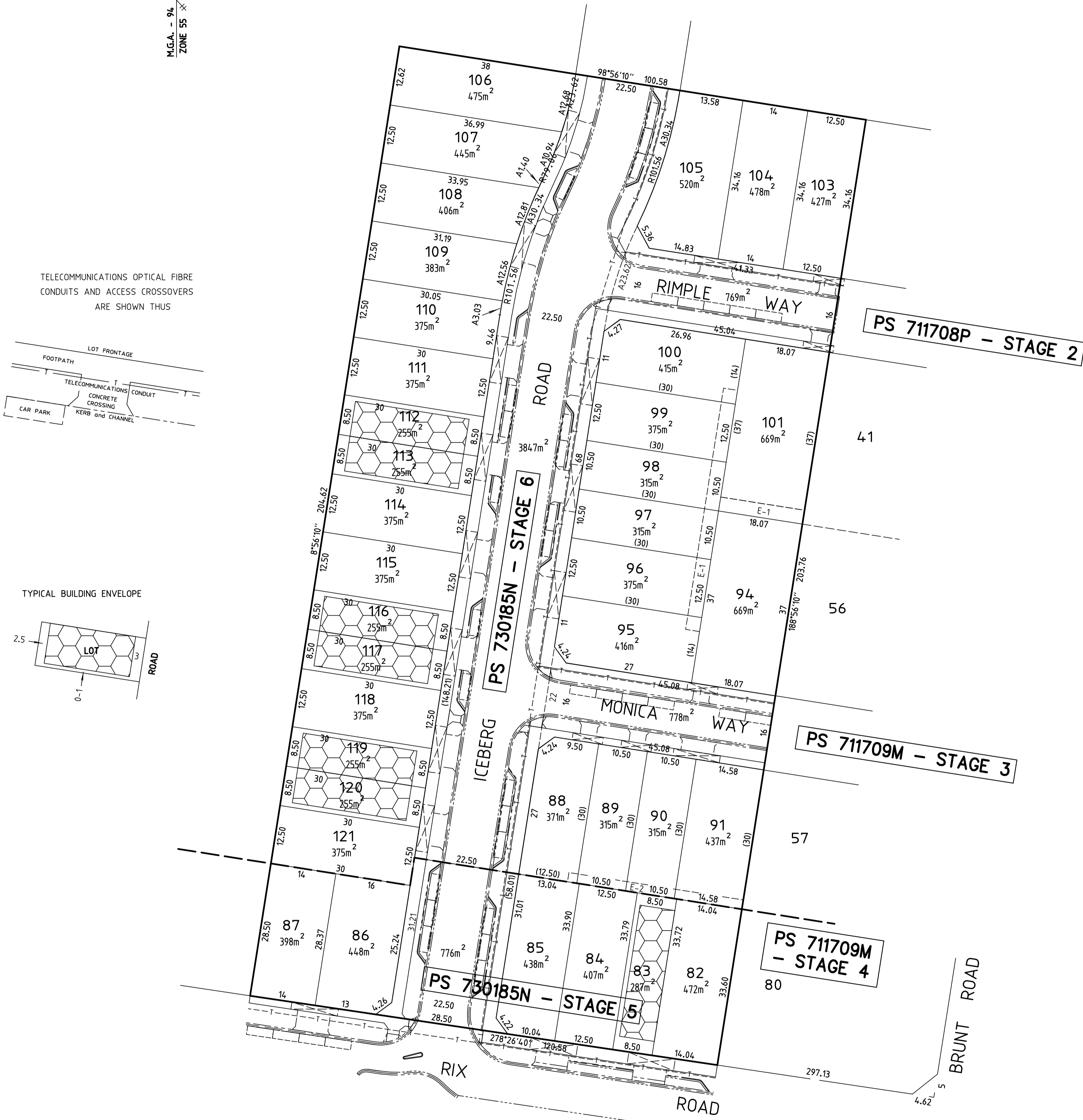

TELECOMMUNICATIONS OPTICAL FIBRE
 CONDUITS AND ACCESS CROSSOVERS
 ARE SHOWN THUS

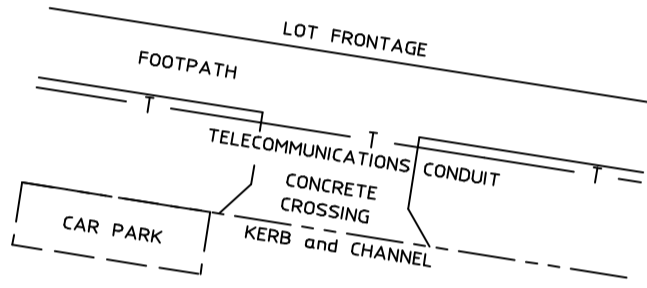

TYPICAL BUILDING ENVELOPE

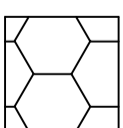
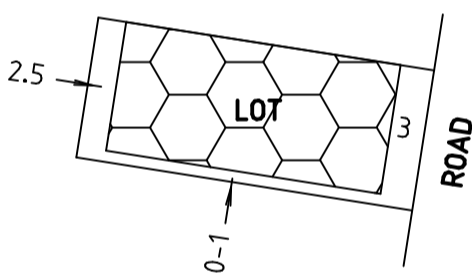

Building Envelope in accordance with Officer PSP - Small Lot Housing Code

LOT SIZE RANGE (m ²)	NUMBER OF LOTS
< 300	7 LOTS
300 - 350	4 LOTS
351 - 400	11 LOTS
401 - 450	9 LOTS
451 - 500	3 LOTS
500 +	3 LOTS
TOTAL	37 LOTS

Total Area : 2.054ha No. of Lots : 37
 Lots per Hectare : 18.01
 Total Area Roads : 6170m²

COMPUTER REF : 802887

RODNEY AUJARD & ASSOCIATES
 LICENSED LAND SURVEYORS
 Level 1, 325 Camberwell Road, Camberwell, 3124
 ph: 9813 2222 fax: 9813 2244
 EMAIL: aujard@bigpond.net.au

EASEMENT	PURPOSE	WIDTH (metres)	ORIGIN	LAND BENEFITED / IN FAVOUR OF
E-1	DRAINAGE	3	THIS PLAN	CARDINIA SHIRE COUNCIL
	SEWERAGE	3	THIS PLAN	SOUTH EAST WATER CORPORATION
E-2	SEWERAGE	2	THIS PLAN	SOUTH EAST WATER CORPORATION